





Manchester Evening Herald

Published Every Evening except Sundays... Subscription Rates: One Year \$12.00, Six Months \$7.00, Three Months \$4.00.

Again, Somebody Else Is First

It rather looks as if somebody had gone and done it right under our nose again. Somebody has gone ahead and invented one of those things most of us have always been going to invent, when, some day, a brilliant idea swooped down and gave itself up to us.

We don't know, for sure, whether the new vinyl see-through dome shape umbrella, with easy-walking room for two if necessary, is going to prove a permanent success.

How many years has the new invention been there, waiting for somebody to make it? Since at least 1771, the date on which the first umbrella may have been sold in Baltimore.

Cain And Abel, 1972

Once again capital punishment is up for public reconsideration. This time through the courts, with arguments being fought out on constitutional rather than moral or religious grounds.

The Supreme Court of New Jersey has just ruled capital punishment unconstitutional, as written in the state constitution. The court found this process contrary to the Fifth Amendment which guarantees freedom from the need to incriminate oneself.

The court's action automatically executed 20 New Jersey convicts from the electric chair. Their sentences will be reduced to life imprisonment. Across the country, however, 670 other men and seven women in 34 states are awaiting a ruling by the Supreme Court of the United States.

The arguments in the highest court are being fought on grounds that the rights of the condemned man are being infringed under the 8th Amendment, which forbids "cruel and unusual punishment."

Should the court decide otherwise, then the whole issue is left wide open, and with it a host of questions. Primary among these is what action to take about the 670 condemned prisoners who now sit in death-row cells. Pending this case, there has not been an execution since June, 1967.



ST. JAMES CHURCH Photographed by William Cole

Inside Report Hoover's Empire Abroad

By Rowland Evans Jr. and Robert D. Novak

WASHINGTON — J. Edgar Hoover has quietly won an executive order from President Nixon's approval for a proposed opening new offices in six additional cities: Manila, Rio de Janeiro, Singapore, New Delhi, Canberra and Santo Domingo.

In other words, Secretary of State William Rogers, who as Attorney General under President Eisenhower in the late 1950s gave Hoover free rein at the FBI, decided not to make an issue of Hoover's worldwide expansionism.

The overseas FBI agents are called, officially and euphemistically, "legal attaches" and are assigned to U.S. embassies abroad. Legal attaches have long performed useful work in Ottawa and Mexico City, helping track down fugitives.

But Hoover has gone far beyond this. Shielded from public and Congressional scrutiny, he has quietly built an overseas network of FBI agents in 20 countries. The latest step came last year when the director proposed expansion into another dozen capitals, and showed off his legend of the director's bureaucratic juggling by going right to the top for approval.

Connecticut Yankee

By A.H.O.

We still have our secret operative very close to the installation of a micrograph machine in the field division of the casualty-property personal lines department.

But its existence has to be deduced from its products, and the message it gives through its products turns out to be an urgent message to Democratic State Chairman John Bailey warning him that, after all these years, he had better face up to the problem of getting himself, and using a micrograph machine.

We can appreciate that it has been a very nice thing for John Bailey to be able to lead his party for a whole quarter of a century without a micrograph machine, but we can also understand our own opinion that it has been a sharp situation of the man and the public to be excused, all these years, from the grim task of handling various public issues of the day.

Whenever operating the New Haven machine, political or micrograph, has lately begun to make its services available to Democratic politicians anywhere in the state who might conceivably be sympathetic to the New Haven project for throwing Mr. Bailey out of party office.

Herald Yesterdays

25 Years Ago "Rita Brand Fireware" is manufactured by Becher Corporation, Manchester, a new glassware industry.

10 Years Ago General Manager Richard Martin estimates \$400,000 as cost of two proposed new firehouses on Center St. and McKee St.

Current Quotes

"It came on a Nixon power. Blow any spitting." — Sen. Hubert H. Humphrey, D-Minn., after an engine on his campaign plane failed and he was forced to land in Detroit.

Fischetti



Business Bodies

THREE PROMOTED

Three Manchester residents have received promotions at The Travelers Insurance Co. in Hartford. H. Peyton Burr Jr., 47, Tudor Lane, has been named supervising marketing analyst in the field division of the casualty-property personal lines department.

Paul H. Inderbitzin of 1202 W. Middle Tpk., was named actuarial analyst in the casualty-property actuarial department. Inderbitzin came to The Travelers in 1970 as a college trainee. He received a BA degree from Southeastern Louisiana University.

IN BANK POST Richard L. Card of Granby has been named assistant secretary of the Connecticut Bank and Trust Co. Appointed assistant head of the institutional group in trust administration.

IN PRESIDENT'S CLUB Leonard D. Rivard of the Connecticut Savings and Loan Association, Inc., at 387 E. Center St., has been selected for membership in the Kemper Insurance President's Club, the highest accolade granted by the Illinois-based Kemper Insurance Group for outstanding sales and service accomplishments.

ON REGION COUNCIL Herbert E. Johnson of 307 Spring St., senior vice president of Connecticut Natural Gas Corp., has been appointed chairman of the regional council.

ANNUAL MEETING SLATED The annual meeting of the Manchester Savings and Loan Association, Inc., will be held at the main office, 1007 Main St., Jan. 28 at 7:30 p.m.

PRODUCE SHOW SLATED The South Windsor Chamber of Commerce and Rotary Club are again sponsoring a produce show to be held Friday, April 21 and Saturday, April 22 at South Windsor High School.

NOTE PRICE SUPPORTS Broadleaf and Havana tobacco growers of the Connecticut Valley have voted to continue the marketing quota and price support program for another three years, according to Harold D. Zilvort, chairman of the Hartford County ABA Committee.

JOBS CLAIMS Unemployment compensation claims filed in Manchester for the week ended Jan. 8 totaled 2,914, a 1.9 per cent increase over the previous week, the state labor department reports.

AETNA SPECIALIST Gordon L. Matsumo of 231 Wells St. has been named plan revision specialist in the group benefits department at Aetna Life and Casualty in Hartford.

Church of Christ To Hear Guest

David Tarbet, minister of the Church of Christ in Danbury, will be the guest speaker tomorrow evening as part of a program of pulp exchange between churches of Christ in Connecticut.

Tarbet, minister of the Danbury church for the past five years, received his BA degree from Abilene Christian College and recently completed requirements for an MA degree in religious education from the University of Bridgeport. As a youth, he spent several years in Australia, where his father was a missionary for the church.

Secretary of the State, Treasurer and Comptroller from \$15,000 to \$25,000. Senate president pro tem and speaker of the House from \$4,000 a year to \$9,000. Senate and House majority and minority leaders from \$4,000 a year to \$8,000.

Chief justice and chief court administrator from \$33,000 to \$42,000. Chief judge of the circuit court from \$23,000 to \$30,000. Under the present system, state legislators get a base salary of \$4,000 for a two-year term, plus mileage payments, and \$25 for each day of committee work they do between legislative sessions.

NEW - EXCITING NATURAL HEALTH FOOD SHOPPE AT THE PARKADE

party supplies for all occasions! Find it at FAIRWAY we give organizational discounts too!

WILD CARGO PET SHOPS

MANCHESTER PARKADE iggell DRUG STORE

NOTICE: OPEN ALL DAY SUNDAY 8 A.M. - 9 P.M. 404 WEST MIDDLE TURNPIKE

Munson's Candy Kitchen Where Quality Candy Is Made Fresh Daily Choose From Over 100 Varieties

CHUNK CHOCOLATE Chunky solid pieces of our smooth, rich, milk and dark chocolate and white, M-M-M-Good!

ROUTE 6, BOLTON - TEL. 649-4332 OPEN DAILY AND SUNDAY 8:30 A.M. - 5:00 P.M. Candy Also Available For Fund Raising

Business Bodies

THREE PROMOTED

Three Manchester residents have received promotions at The Travelers Insurance Co. in Hartford. H. Peyton Burr Jr., 47, Tudor Lane, has been named supervising marketing analyst in the field division of the casualty-property personal lines department.

Paul H. Inderbitzin of 1202 W. Middle Tpk., was named actuarial analyst in the casualty-property actuarial department. Inderbitzin came to The Travelers in 1970 as a college trainee. He received a BA degree from Southeastern Louisiana University.

IN BANK POST Richard L. Card of Granby has been named assistant secretary of the Connecticut Bank and Trust Co. Appointed assistant head of the institutional group in trust administration.

IN PRESIDENT'S CLUB Leonard D. Rivard of the Connecticut Savings and Loan Association, Inc., at 387 E. Center St., has been selected for membership in the Kemper Insurance President's Club, the highest accolade granted by the Illinois-based Kemper Insurance Group for outstanding sales and service accomplishments.

ON REGION COUNCIL Herbert E. Johnson of 307 Spring St., senior vice president of Connecticut Natural Gas Corp., has been appointed chairman of the regional council.

ANNUAL MEETING SLATED The annual meeting of the Manchester Savings and Loan Association, Inc., will be held at the main office, 1007 Main St., Jan. 28 at 7:30 p.m.

PRODUCE SHOW SLATED The South Windsor Chamber of Commerce and Rotary Club are again sponsoring a produce show to be held Friday, April 21 and Saturday, April 22 at South Windsor High School.

NOTE PRICE SUPPORTS Broadleaf and Havana tobacco growers of the Connecticut Valley have voted to continue the marketing quota and price support program for another three years, according to Harold D. Zilvort, chairman of the Hartford County ABA Committee.

JOBS CLAIMS Unemployment compensation claims filed in Manchester for the week ended Jan. 8 totaled 2,914, a 1.9 per cent increase over the previous week, the state labor department reports.

AETNA SPECIALIST Gordon L. Matsumo of 231 Wells St. has been named plan revision specialist in the group benefits department at Aetna Life and Casualty in Hartford.

THOMAS W. FRECKLETON Windsor, offering real estate investment consulting services, incorporated Hartford National Bank and Trust, has announced a decrease of 7.6 per cent in consolidated income for 1971. The 1971 total was \$9.18 million, compared to \$9.8 million in 1970.

HONORED BY HOOD Roy E. Colmer of Riverside Dr., Vernon, was honored by the Agawam home delivery branch winners at the luncheon in Lynnfield, Mass.

THE FELEWAY CORP. The Feleway Corp., which operates Shop-Town at the new Putnam shopping center at Spencer St. and Ellistown Rd., has reported record sales in its 59-outlet chain for December. For the five weeks ending Jan. 1, Feleway's sales totaled \$4.5 million, up 6.5 per cent from the comparable period in December 1970.

CITIZENS INSURANCE CO. OF NEW JERSEY, an affiliate of The Hartford Insurance Group since 1929, has changed its corporate name to Hartford Casualty Insurance Co. The Hartford Insurance Group, an affiliate of International Telephone and Telegraph Corp., includes the parent Hartford Fire Insurance Co., Hartford Accident and Indemnity Co., Hartford Life Insurance Co., and others.

ROYAL ARMS, a 77-unit townhouse complex on Main St. in Manchester, has been sold for \$489,800 to Royal Arms, Ltd., a limited real estate investment partnership with the D. J. Henry Co., a South Windsor real estate consulting firm. The purchase, arranged by D. J. Henry with individual investors putting up \$1,071 per partnership share, was completed Monday.

Salary Hikes Asked For State Officials

HARTFORD (AP) — The governor, the legislators and the judges of Connecticut are not being paid nearly enough money, the Commission on Compensation said Friday.

The commission said its goal was to raise salaries to the point where they would not deter or prevent any qualified Connecticut citizen from seeking election or accepting appointment to public office or state.

It recommended boosting the governor's pay from \$35,000 a year to \$45,000, legislators' pay from \$12,750 a year to \$17,500, Supreme Court justices' pay from \$27,500 to \$37,000, Superior Court judges' pay from \$22,500 to \$32,500, Circuit Court judges' pay from \$21,500 to \$27,500, and juvenile court judges' pay from \$20,000 to \$27,500.

Although not yet a full-time job, lieutenant governor should have his pay doubled to \$20,000, and he should have his own office budget separate from the governor's office budget, the commission said.

In addition to the salary hikes listed above, the commission also recommended the following increases: —Attorney General from \$20,000 to \$30,000. —Secretary of the State, Treasurer and Comptroller from \$15,000 to \$25,000. —Senate president pro tem and speaker of the House from \$4,000 a year to \$9,000. —Senate and House majority and minority leaders from \$4,000 a year to \$8,000. —Chief justice and chief court administrator from \$33,000 to \$42,000. —Chief judge of the circuit court from \$23,000 to \$30,000. Under the present system, state legislators get a base salary of \$4,000 for a two-year term, plus mileage payments, and \$25 for each day of committee work they do between legislative sessions.

THE FELEWAY CORP. The Feleway Corp., which operates Shop-Town at the new Putnam shopping center at Spencer St. and Ellistown Rd., has reported record sales in its 59-outlet chain for December. For the five weeks ending Jan. 1, Feleway's sales totaled \$4.5 million, up 6.5 per cent from the comparable period in December 1970.

CITIZENS INSURANCE CO. OF NEW JERSEY, an affiliate of The Hartford Insurance Group since 1929, has changed its corporate name to Hartford Casualty Insurance Co. The Hartford Insurance Group, an affiliate of International Telephone and Telegraph Corp., includes the parent Hartford Fire Insurance Co., Hartford Accident and Indemnity Co., Hartford Life Insurance Co., and others.

ROYAL ARMS, a 77-unit townhouse complex on Main St. in Manchester, has been sold for \$489,800 to Royal Arms, Ltd., a limited real estate investment partnership with the D. J. Henry Co., a South Windsor real estate consulting firm. The purchase, arranged by D. J. Henry with individual investors putting up \$1,071 per partnership share, was completed Monday.

THOMAS W. FRECKLETON Windsor, offering real estate investment consulting services, incorporated Hartford National Bank and Trust, has announced a decrease of 7.6 per cent in consolidated income for 1971. The 1971 total was \$9.18 million, compared to \$9.8 million in 1970.

HONORED BY HOOD Roy E. Colmer of Riverside Dr., Vernon, was honored by the Agawam home delivery branch winners at the luncheon in Lynnfield, Mass.

THE FELEWAY CORP. The Feleway Corp., which operates Shop-Town at the new Putnam shopping center at Spencer St. and Ellistown Rd., has reported record sales in its 59-outlet chain for December. For the five weeks ending Jan. 1, Feleway's sales totaled \$4.5 million, up 6.5 per cent from the comparable period in December 1970.

CITIZENS INSURANCE CO. OF NEW JERSEY, an affiliate of The Hartford Insurance Group since 1929, has changed its corporate name to Hartford Casualty Insurance Co. The Hartford Insurance Group, an affiliate of International Telephone and Telegraph Corp., includes the parent Hartford Fire Insurance Co., Hartford Accident and Indemnity Co., Hartford Life Insurance Co., and others.

ROYAL ARMS, a 77-unit townhouse complex on Main St. in Manchester, has been sold for \$489,800 to Royal Arms, Ltd., a limited real estate investment partnership with the D. J. Henry Co., a South Windsor real estate consulting firm. The purchase, arranged by D. J. Henry with individual investors putting up \$1,071 per partnership share, was completed Monday.

THOMAS W. FRECKLETON Windsor, offering real estate investment consulting services, incorporated Hartford National Bank and Trust, has announced a decrease of 7.6 per cent in consolidated income for 1971. The 1971 total was \$9.18 million, compared to \$9.8 million in 1970.

HONORED BY HOOD Roy E. Colmer of Riverside Dr., Vernon, was honored by the Agawam home delivery branch winners at the luncheon in Lynnfield, Mass.



BUGS BUNNY comic strip panels showing Bugs Bunny and Daffy Duck in a car.

MICKY FINN comic strip panels featuring Micky Finn and a woman.

FRISCILLA'S POP comic strip panels with Friscilla and a man.

GUMMER STREET comic strip panels showing a man and a woman.

PLAIN JANE comic strip panels with Plain Jane and a man.

MR. ABERNATHY comic strip panels featuring Mr. Abernathy.

BUZZ SAWYER comic strip panels with Buzz Sawyer.

ALLEY OOP comic strip panels showing a man in an alley.

LANCELOT comic strip panels with Lancelot and a woman.

OUR BOARDING HOUSE with MAJOR HOOPLE comic strip panels.

OUT OUR WAY BY NED COCHRAN comic strip panels.

SHORT RIBS BY FRANK ONEAL comic strip panels.

WINTHROP comic strip panels with a man and a woman.

CAPTAIN EASY comic strip panels featuring Captain Easy.

ALLEY OOP comic strip panels with a man in an alley.

STEVE CANYON comic strip panels with Steve Canyon.

LITTLE SPORTS comic strip panels with a man and a woman.

THE RACE IS ON TELEVISION comic strip panels.

Here and There crossword puzzle grid.

CARNIVAL BY DICK TURNER comic strip panels.

MEMORIAL CORNER STORE advertisement for party goods.

YOUR COMPLETE PET CENTER advertisement for pet supplies.

SEE US FOR QUALITY TAILORING AND CUSTOM MADE SUITS advertisement.

Radio of the Week advertisement for radio listings.

Foreign Car Repairs advertisement for car services.

Got A Painting Problem? We'll Help! advertisement for painting services.

E.A. Johnson PAINT CO. advertisement for paint products.

BUSINESS SERVICES DIRECTORY

LAUNDRY AND DRY CLEANING advertisement for L.U.C.A.'S.

CAMPING EQUIPMENT advertisement for tents and gear.

Ostrinsky DEALER IN WASTE MATERIALS advertisement.

MERCURY Travel Agency advertisement for travel services.

FUEL OIL 17.9 GAL. C.O.D. advertisement for fuel services.

SEE US FOR QUALITY TAILORING AND CUSTOM MADE SUITS advertisement.

Radio of the Week advertisement for radio listings.

Foreign Car Repairs advertisement for car services.

Got A Painting Problem? We'll Help! advertisement for painting services.

P & M UPHOLSTERY SHOP advertisement for upholstery services.

Reupholster in Winter advertisement for upholstery.

YOUR COMPLETE PET CENTER advertisement for pet supplies.

SEE US FOR QUALITY TAILORING AND CUSTOM MADE SUITS advertisement.

Radio of the Week advertisement for radio listings.

Foreign Car Repairs advertisement for car services.

Got A Painting Problem? We'll Help! advertisement for painting services.

E.A. Johnson PAINT CO. advertisement for paint products.

HIGH GRADE PRINTING advertisement for printing services.

MANCHESTER Seafood advertisement for seafood products.

Reuben Plen's Texaco Station advertisement for a gas station.

TOURNAINE PAINTS advertisement for paint products.

PAUL'S PAINT SUPPLY advertisement for paint products.

OPEN SAT. TO 1 P.M. advertisement for a business.

DIAMONDS FROM JEWELRY STORE advertisement for jewelry.

Foreign Car Repairs advertisement for car services.

Got A Painting Problem? We'll Help! advertisement for painting services.

McDonald's HAMBURGERS advertisement for fast food.

# Indians Twice Overcome Big Deficits to Triumph Over Wethersfield

By DEAN YOST

Trailing twice by as many as 14 points in the third quarter, a stubborn Manchester High five came away from Wethersfield last night owning a thrilling 66-61 victory. The win upped the Tribes' record to 6-4 in the league and 6-4 overall. It also snapped a two-game losing skid. Wethersfield had sports a 2-7 and 2-9 overall.

Manchester High controlled the opening up and in the first eight minutes of hard-nosed basketball the lead changed hands 12 different times and the Tribes won five times. It was 16-16 entering the second period. Rick Kiernan and Mike Mistrizzi carried the bulk of the Indiana's scoring with 11 points. Pete Krucinski, a towering 6-4 center, netted seven markers to keep Wethersfield in contention.

It appeared that the Tribes would open this margin up in the second quarter but instead Wethersfield became hot and took advantage of numerous Manchester mistakes. Krucinski was the big gun for the Eagles and opened up a nine-point margin, 39-30 at the half. He also hit a 23-point quarter. Despite getting a sound talking to at the break by Indian coach Larry Ayers, Manchester fell further behind 48-32, entering the third quarter.

Nothing seemed to go the local way until 3:14 when John Herds became a hero. He hit the Tribes outside the Eagles 19-37 in the third quarter and scored the fourth trailing, 56-48.

With the near-capacity crowd screaming and beginning to realize that Manchester was on the move, play started to get ragged, with a few minor flare-ups taking place.

It took Wethersfield until 2:20 remained on the clock for the first field goal of the fourth quarter. In the meantime the Indians tallied 10 points in the game, 56-56, with 6:33 showing when Kiernan tapped in a rebound shot.

Now Manchester was in control and Dan Carlson sank a key foul shot at 1:13 making it 64-56.

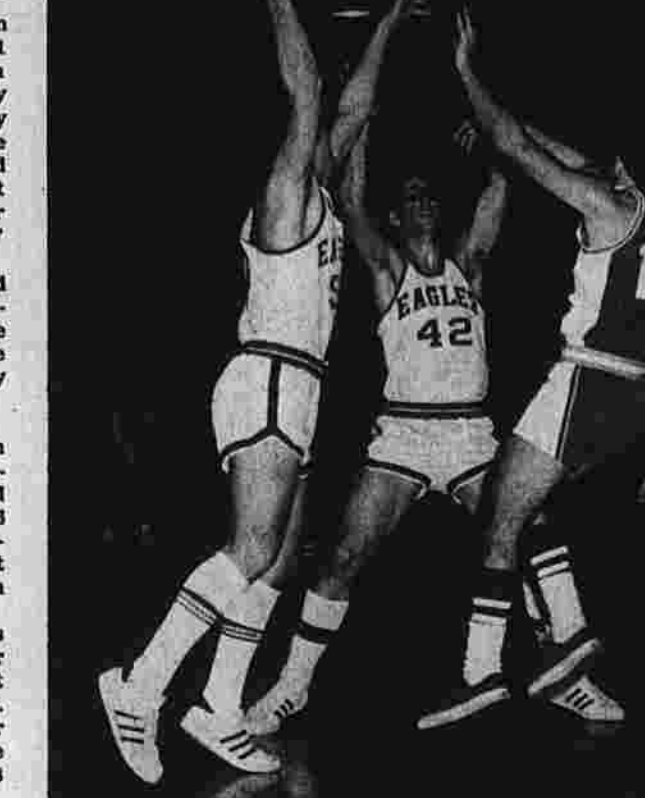

Manchester's Pete Krucinski (left) and Wethersfield's John Herds (right) in action during the game.



Manchester's Pete Krucinski (left) and Wethersfield's John Herds (right) in action during the game.

Manchester (66) 21 14 11 20  
Wethersfield (61) 14 14 13 20

Manchester (66) 21 14 11 20  
Wethersfield (61) 14 14 13 20

Manchester (66) 21 14 11 20  
Wethersfield (61) 14 14 13 20

Manchester (66) 21 14 11 20  
Wethersfield (61) 14 14 13 20

Manchester (66) 21 14 11 20  
Wethersfield (61) 14 14 13 20

Manchester (66) 21 14 11 20  
Wethersfield (61) 14 14 13 20

Manchester (66) 21 14 11 20  
Wethersfield (61) 14 14 13 20

Manchester (66) 21 14 11 20  
Wethersfield (61) 14 14 13 20

Manchester (66) 21 14 11 20  
Wethersfield (61) 14 14 13 20

Manchester (66) 21 14 11 20  
Wethersfield (61) 14 14 13 20

Manchester (66) 21 14 11 20  
Wethersfield (61) 14 14 13 20

Manchester (66) 21 14 11 20  
Wethersfield (61) 14 14 13 20

Manchester (66) 21 14 11 20  
Wethersfield (61) 14 14 13 20

Manchester (66) 21 14 11 20  
Wethersfield (61) 14 14 13 20

Manchester (66) 21 14 11 20  
Wethersfield (61) 14 14 13 20

Manchester (66) 21 14 11 20  
Wethersfield (61) 14 14 13 20

Manchester (66) 21 14 11 20  
Wethersfield (61) 14 14 13 20

Manchester (66) 21 14 11 20  
Wethersfield (61) 14 14 13 20

Manchester (66) 21 14 11 20  
Wethersfield (61) 14 14 13 20

Manchester (66) 21 14 11 20  
Wethersfield (61) 14 14 13 20

Manchester (66) 21 14 11 20  
Wethersfield (61) 14 14 13 20

Manchester (66) 21 14 11 20  
Wethersfield (61) 14 14 13 20

Manchester (66) 21 14 11 20  
Wethersfield (61) 14 14 13 20

Manchester (66) 21 14 11 20  
Wethersfield (61) 14 14 13 20

Manchester (66) 21 14 11 20  
Wethersfield (61) 14 14 13 20

Manchester (66) 21 14 11 20  
Wethersfield (61) 14 14 13 20

Manchester (66) 21 14 11 20  
Wethersfield (61) 14 14 13 20

Manchester (66) 21 14 11 20  
Wethersfield (61) 14 14 13 20

Manchester (66) 21 14 11 20  
Wethersfield (61) 14 14 13 20

Manchester (66) 21 14 11 20  
Wethersfield (61) 14 14 13 20

Manchester (66) 21 14 11 20  
Wethersfield (61) 14 14 13 20

Manchester (66) 21 14 11 20  
Wethersfield (61) 14 14 13 20

Manchester (66) 21 14 11 20  
Wethersfield (61) 14 14 13 20

Manchester (66) 21 14 11 20  
Wethersfield (61) 14 14 13 20

Manchester (66) 21 14 11 20  
Wethersfield (61) 14 14 13 20

Manchester (66) 21 14 11 20  
Wethersfield (61) 14 14 13 20

Manchester (66) 21 14 11 20  
Wethersfield (61) 14 14 13 20

Manchester (66) 21 14 11 20  
Wethersfield (61) 14 14 13 20

Manchester (66) 21 14 11 20  
Wethersfield (61) 14 14 13 20

Manchester (66) 21 14 11 20  
Wethersfield (61) 14 14 13 20

Manchester (66) 21 14 11 20  
Wethersfield (61) 14 14 13 20

Manchester (66) 21 14 11 20  
Wethersfield (61) 14 14 13 20

Manchester (66) 21 14 11 20  
Wethersfield (61) 14 14 13 20

Manchester (66) 21 14 11 20  
Wethersfield (61) 14 14 13 20

Manchester (66) 21 14 11 20  
Wethersfield (61) 14 14 13 20

Manchester (66) 21 14 11 20  
Wethersfield (61) 14 14 13 20

Manchester (66) 21 14 11 20  
Wethersfield (61) 14 14 13 20

Manchester (66) 21 14 11 20  
Wethersfield (61) 14 14 13 20

Manchester (66) 21 14 11 20  
Wethersfield (61) 14 14 13 20

Manchester (66) 21 14 11 20  
Wethersfield (61) 14 14 13 20

Manchester (66) 21 14 11 20  
Wethersfield (61) 14 14 13 20

Manchester (66) 21 14 11 20  
Wethersfield (61) 14 14 13 20

Manchester (66) 21 14 11 20  
Wethersfield (61) 14 14 13 20

Manchester (66) 21 14 11 20  
Wethersfield (61) 14 14 13 20

Manchester (66) 21 14 11 20  
Wethersfield (61) 14 14 13 20

Manchester (66) 21 14 11 20  
Wethersfield (61) 14 14 13 20

Manchester (66) 21 14 11 20  
Wethersfield (61) 14 14 13 20

Manchester (66) 21 14 11 20  
Wethersfield (61) 14 14 13 20

Manchester (66) 21 14 11 20  
Wethersfield (61) 14 14 13 20

Manchester (66) 21 14 11 20  
Wethersfield (61) 14 14 13 20

Manchester (66) 21 14 11 20  
Wethersfield (61) 14 14 13 20

Manchester (66) 21 14 11 20  
Wethersfield (61) 14 14 13 20

# Ken Tomczuk Stars In Eye-Filling Show

By EARL YOST

Returning to early season before a capacity crowd at home last night, East Catholic High's well-oiled machine advanced within one game of qualifying for the annual CIAC Class A tournament with an easy victory. The latest victim was East Hartford High and the Eagles barely worked up a sweat in posting an impressive 84-71 triumph.

The success was the 10th in 12 starts in nine straight games — and the fourth straight after building up a comfortable 30-point edge. Coach Stan Tomczuk removed his starters with six minutes left in the first half and the Hornets finished with a rush, cutting the final margin down to 18 points.

Once again Tomczuk put everything together, with Ken Tomczuk leading the offense in pace and Tom Kraus and Jerry Tierney doing dual jobs of the boards and in putting the ball through the hoop.

Nine for 10 from Tomczuk, who led in shooting his "slump." He earned nine of 15 attempts from the floor and wound up with 19 points to take team scoring honors. Tierney dropped in 16 more points and Tom Kraus added 14 points. Tomczuk's Steve Krajewski again playing a strong game as Skip Pope, Steve and Coombes added 10, 10 and 10 markers for the winners.

Rockville's Steve Krajewski pumped in 19 to share game scoring honors. Teammates Mike Ayres and Joe Hoernemann added 17 and 16 points, respectively.

Need One More Win  
A win Tuesday night at home against Xavier will send the Eagles to another post-season show.

Manchester (66) 21 14 11 20  
Wethersfield (61) 14 14 13 20

Manchester (66) 21 14 11 20  
Wethersfield (61) 14 14 13 20

Manchester (66) 21 14 11 20  
Wethersfield (61) 14 14 13 20

Manchester (66) 21 14 11 20  
Wethersfield (61) 14 14 13 20

Manchester (66) 21 14 11 20  
Wethersfield (61) 14 14 13 20

Manchester (66) 21 14 11 20  
Wethersfield (61) 14 14 13 20

Manchester (66) 21 14 11 20  
Wethersfield (61) 14 14 13 20

Manchester (66) 21 14 11 20  
Wethersfield (61) 14 14 13 20

Manchester (66) 21 14 11 20  
Wethersfield (61) 14 14 13 20

Manchester (66) 21 14 11 20  
Wethersfield (61) 14 14 13 20

Manchester (66) 21 14 11 20  
Wethersfield (61) 14 14 13 20

Manchester (66) 21 14 11 20  
Wethersfield (61) 14 14 13 20

Manchester (66) 21 14 11 20  
Wethersfield (61) 14 14 13 20

Manchester (66) 21 14 11 20  
Wethersfield (61) 14 14 13 20

Manchester (66) 21 14 11 20  
Wethersfield (61) 14 14 13 20

Manchester (66) 21 14 11 20  
Wethersfield (61) 14 14 13 20

Manchester (66) 21 14 11 20  
Wethersfield (61) 14 14 13 20

Manchester (66) 21 14 11 20  
Wethersfield (61) 14 14 13 20

Manchester (66) 21 14 11 20  
Wethersfield (61) 14 14 13 20

Manchester (66) 21 14 11 20  
Wethersfield (61) 14 14 13 20

Manchester (66) 21 14 11 20  
Wethersfield (61) 14 14 13 20

Manchester (66) 21 14 11 20  
Wethersfield (61) 14 14 13 20

Manchester (66) 21 14 11 20  
Wethersfield (61) 14 14 13 20

Manchester (66) 21 14 11 20  
Wethersfield (61) 14 14 13 20

Manchester (66) 21 14 11 20  
Wethersfield (61) 14 14 13 20

Manchester (66) 21 14 11 20  
Wethersfield (61) 14 14 13 20

Manchester (66) 21 14 11 20  
Wethersfield (61) 14 14 13 20

Manchester (66) 21 14 11 20  
Wethersfield (61) 14 14 13 20

Manchester (66) 21 14 11 20  
Wethersfield (61) 14 14 13 20

Manchester (66) 21 14 11 20  
Wethersfield (61) 14 14 13 20

Manchester (66) 21 14 11 20  
Wethersfield (61) 14 14 13 20

# Little Black Book Notes

Big winner in Sunday night's basketball exhibition at the Clarke Arena between the Cops and Robbers (where did the area clergy ever get his bags) was the CTO and Manchester Drug Advisory Council. Action starts at 6:30 with a preliminary game with Sam Matheo leading the Cops against the Robbers in the main event at 8. Tickets will be available at the door, speaking of benefits, Ray Peck (also a policeman) sends word that Jimmy Fund Committee will meet Wednesday night to formulate plans for the 1972 presentation at Charter Oak Park. Peck, who will serve as general chairman, reports \$24,437 has been collected in the past eight years and turned over to the Jimmy Fund. Last summer's campaign netted \$22,821. Peck's committee will be John McFarland, Phil Burgess, Carl Bieri, Jon Hawthorne, Dick Smith and George McCaughey. Also Ostrinsky, Joe Globe and Joe Lutz. Springfield Kings entertain Cleveland tonight at 7:30 in an American Hockey League game starting at 7 o'clock. Manchester High basketball coach, Tom Kraus, has a six-man varsity with the remainder of his squad being made up of underclassmen who performed well in Pearson's jayvee squad. Rick Haberern is the only senior with the Indian varsity. Note that there is an annual static about athletic teams carrying the name of Indians will Manchester High. It is a heavy Orogundis and does, but the smaller Eagles beat the Hornets on the board with surprising ease. The Hornets suffered with the ball down court, with fast breaks, proved too much for the visitors.

East never trailed and after East Hartford led the count at 11-0, the Eagles were in the lead, leading at all the breaks, 16-9, 34-22 and 58-28.

Bright spots were the invaders and hard-working Bob Blass and Andy Bob Klicher. Tom Kraus performed very well. The letter carried 10 in the final quarter and Blass scored in 16 more points and Tom Kraus with 19 points to take team scoring honors. Tierney dropped in 16 more points and Tom Kraus added 14 points. Tomczuk's Steve Krajewski again playing a strong game as Skip Pope, Steve and Coombes added 10, 10 and 10 markers for the winners.

Rockville's Steve Krajewski pumped in 19 to share game scoring honors. Teammates Mike Ayres and Joe Hoernemann added 17 and 16 points, respectively.

Need One More Win  
A win Tuesday night at home against Xavier will send the Eagles to another post-season show.

Manchester (66) 21 14 11 20  
Wethersfield (61) 14 14 13 20

Manchester (66) 21 14 11 20  
Wethersfield (61) 14 14 13 20

Manchester (66) 21 14 11 20  
Wethersfield (61) 14 14 13 20

Manchester (66) 21 14 11 20  
Wethersfield (61) 14 14 13 20

Manchester (66) 21 14 11 20  
Wethersfield (61) 14 14 13 20

Manchester (66) 21 14 11 20  
Wethersfield (61) 14 14 13 20

Manchester (66) 21 14 11 20  
Wethersfield (61) 14 14 13 20

Manchester (66) 21 14 11 20  
Wethersfield (61) 14 14 13 20

Manchester (66) 21 14 11 20  
Wethersfield (61) 14 14 13 20

Manchester (66) 21 14 11 20  
Wethersfield (61) 14 14 13 20

Manchester (66) 21 14 11 20  
Wethersfield (61) 14 14 13 20

Manchester (66) 21 14 11 20  
Wethersfield (61) 14 14 13 20

Manchester (66) 21 14 11 20  
Wethersfield (61) 14 14 13 20

Manchester (66) 21 14 11 20  
Wethersfield (61) 14 14 13 20

Manchester (66) 21 14 11 20  
Wethersfield (61) 14 14 13 20

Manchester (66) 21 14 11 20  
Wethersfield (61) 14 14 13 20

Manchester (66) 21 14 11 20  
Wethersfield (61) 14 14 13 20

Manchester (66) 21 14 11 20  
Wethersfield (61) 14 14 13 20

Manchester (66) 21 14 11 20  
Wethersfield (61) 14 14 13 20

Manchester (66) 21 14 11 20  
Wethersfield (61) 14 14 13 20

Manchester (66) 21 14 11 20  
Wethersfield (61) 14 14 13 20

Manchester (66) 21 14 11 20  
Wethersfield (61) 14 14 13 20

Manchester (66) 21 14 11 20  
Wethersfield (61) 14 14 13 20

Manchester (66) 21 14 11 20  
Wethersfield (61) 14 14 13 20

Manchester (66) 21 14 11 20  
Wethersfield (61) 14 14 13 20

Manchester (66) 21 14 11 20  
Wethersfield (61) 14 14 13 20

Manchester (66) 21 14 11 20  
Wethersfield (61) 14 14 13 20

Manchester (66) 21 14 11 20  
Wethersfield (61) 14 14 13 20

Manchester (66) 21 14 11 20  
Wethersfield (61) 14 14 13 20

Manchester (66) 21 14 11 20  
Wethersfield (61) 14 14 13 20

Manchester (66) 21 14 11 20  
Wethersfield (61) 14 14 13 20

# College Basketball Roundup

LOS ANGELES (AP) — The UCLA Bruins are no better than an average basketball team. When it comes to fighting, that is.

Santa Clara earned a flustered victory over the Bruins last night, but the Bruins didn't come nearly as close on the road as they did at home.

The second contest saw Community V stopping the Bruins, 65-45, in a game that was a blowout. The Bruins were out of control in the second half, with Santa Clara's 610 center, Steve Stewart, leading the way with 21 points and six rebounds.

Stewart also was deprived of his starting role for the game because of a back injury. He came off the bench to score 14 of his 16 points in the second half, sparking the Bruins' fourth triumph in 13 games.

The pushing continued with the Bruins leading 13-10 at the end of the first half. Santa Clara's 610 center, Steve Stewart, led the way with 21 points and six rebounds.

Stewart also was deprived of his starting role for the game because of a back injury. He came off the bench to score 14 of his 16 points in the second half, sparking the Bruins' fourth triumph in 13 games.

Manchester (66) 21 14 11 20  
Wethersfield (61) 14 14 13 20

Manchester (66) 21 14 11 20  
Wethersfield (61) 14 14 13 20

Manchester (66) 21 14 11 20  
Wethersfield (61) 14 14 13 20

Manchester (66) 21 14 11 20  
Wethersfield (61) 14 14 13 20

Manchester (66) 21 14 11 20  
Wethersfield (61) 14 14 13 20

Manchester (66) 21 14 11 20  
Wethersfield (61) 14 14 13 20



**Rooms Without Board 59 Apartments - Flats - Tenements 63**

**THE THOMPSON HOUSE** - Centrally located, pleasantly furnished, rooms, parking. Call 645-2323 for overnight and permanent guest rates.

**NICE room in private home**, complete home privileges. Phone 645-5275.

**ROOMS for rent**, Manchester Green, complete home privileges. Frigor, water only included. 645-2445.

**WILL share 5-room apartment** with gentleman. Color TV, swimming pool, etc. Call 875-9716.

**LARGE furnished room**, for male only. Parking. \$18 weekly. Call 645-5222 after 5 p.m.

**SINGLE room furnished**, very pleasant. Young working gentleman preferred. Parking, kitchen privileges. 645-9187.

**LARGE ROOM**, nicely furnished, stove, refrigerator, and linen provided. 805 Main St., 645-8302.

**ROOM for lady**, kitchen privileges, on bus line. Call after 5 p.m., 645-5138.

**GENTLEMAN** - Room with home and kitchen privileges, refrigerator, parking, washer and dryer. Call 645-3500.

**PRESIDENTIAL VILLAGE APTS. MANCHESTER**

One and two bedrooms. Immediate occupancy. Near schools, churches and shopping centers on bus line. Call anytime 646-2623

Now completing apartments for occupancy March 1 and April 1.

**Preview Northgate.**

It could be a better buy than your frozen rent.

Included in \$185 to \$195 monthly rentals:

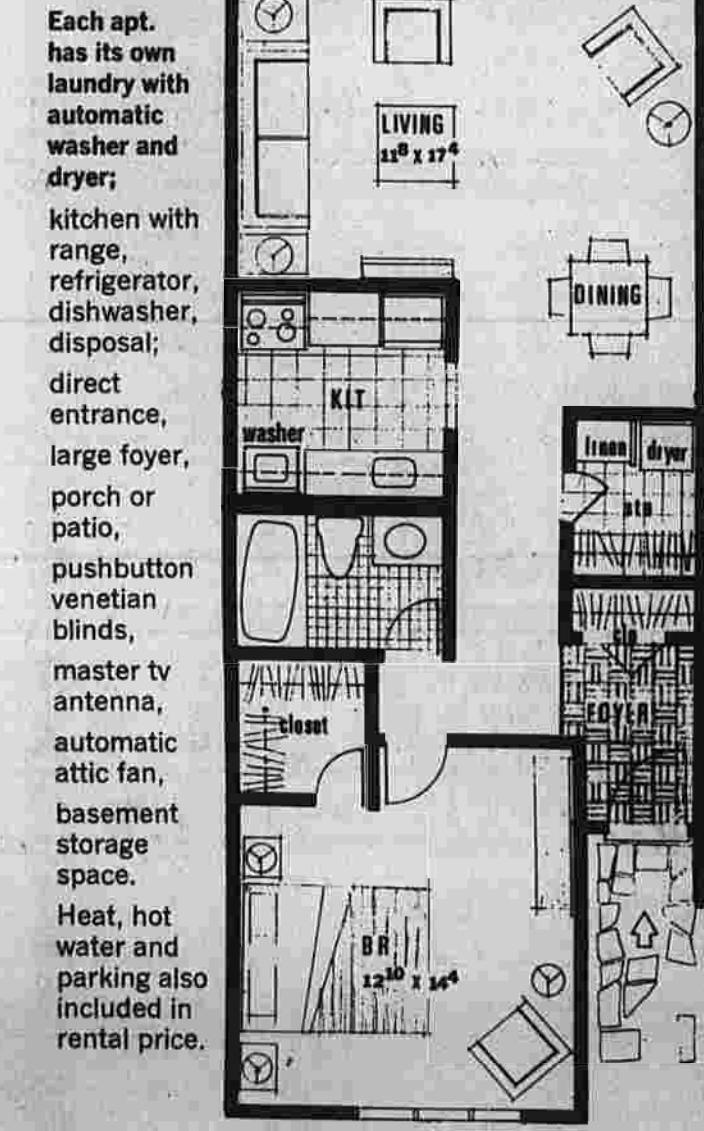

Each apt. has its own laundry with automatic washer and dryer; kitchen with range, refrigerator, dishwasher, disposal; direct entrance, large foyer, porch or patio, pushbutton venetian blinds, master tv antenna, automatic attic fan, basement storage space. Heat, hot water and parking also included in rental price.

**VERNON NORTHGATE SOUTHGATE**

Four minutes from I-84 and I-86 and expressway driving. Ten minutes to Manchester, fifteen to East Hartford, twenty minutes to Hartford. Rental office and model apartment open from 12 noon to 7 p.m. Phone 872-2558 or 875-2709.

**SENIOR CITIZENS DISCOUNT SHOPS**

**10% DISCOUNT**  
To All Gold Card Holders

**FREE CHECKING ACCOUNTS**  
at all Senior Citizens branches.

**GOLD CARDS**  
Gold Cards must be presented at time of purchase. Senior Citizens may obtain these cards at the...

**10% OFF**  
All regular priced merchandise. Sales and fair traded merchandise excluded.

**HOUSE & HALE**  
945 MAIN STREET  
645-4501

**E. A. JOHNSON PAINT CO.**  
723 MAIN STREET  
645-4501

**LIQETT DRUG**  
MANCHESTER PARKADE  
645-4549

**MANCHESTER STATE BANK**  
1041 MAIN STREET  
MANCHESTER  
645-4549

**MANCHESTER HARDWARE & SUPPLY CO.**  
571 MAIN STREET  
645-4545

**PAUL'S PAINT & WALLPAPER SUPPLY**  
945 MAIN STREET  
645-4500

**WATKINS**  
655 MAIN STREET  
MANCHESTER  
645-5111

**ADRIAN'S**  
34 Oak Street  
643-6266

**Senior Citizens Gold Cards are honored at**

**NASSIFF ARMS CO.**  
901 MAIN STREET  
645-9150

**SALEM NASSIFF CAMERA & PHOTO SHOP**  
629 MAIN ST.  
MANCHESTER  
645-7380

**WATKINS**  
655 MAIN STREET  
MANCHESTER  
645-5111

**VERNON NATIONAL BANK**  
VERNON CIRCLE

**Senior Citizens Gold Cards Honored**

**WATKINS**  
655 MAIN STREET  
MANCHESTER  
645-5111

**ADRIAN'S**  
34 Oak Street  
643-6266

**20% DISCOUNT**  
to Senior Citizens all day Monday and Tuesday, 1:30 - 4:30 Wednesday, Thursday and Friday.

**MR. Steak**  
244 Center St., Manchester  
Phone: 646-1905

**WATKINS**  
655 MAIN STREET  
MANCHESTER  
645-5111

**ADRIAN'S**  
34 Oak Street  
643-6266

**50% DISCOUNT**  
To All Senior Citizens. Any Day.

**Adrian's**  
34 Oak Street  
643-6266

**WATKINS**  
655 MAIN STREET  
MANCHESTER  
645-5111

**ADRIAN'S**  
34 Oak Street  
643-6266

**ALSO OFFERING DISCOUNTS TO SENIOR CITIZENS ARE THE FOLLOWING:** Adams Jewelers, Belton Hearing Services, Inc., Billies' Beauty Shop, Capitol Equipment Co., Inc., Conn. Institute of Hairdressing, Cord Casuals, Jon-Ly Coiffures, Land O' Fashion, Logan Mills, Lovely Lady Beauty Salon, Manchester High School, Merle Norman Cosmetics, Pentland The Florist, Petite Beauty Shop, Reed's Inc., The Book Shop, Turnpike Tty, Urbanetti's Shoe Repair Shop, Vincent's Food Haven, Sam Yulies.

**NUTMEG HOMES, INC.** - has a well earned reputation for quality of construction and excellence of design. We invite comparison for size and quality! Our sales are good come see why.

**BELFIE AGENCY REALTORS**  
647-1413

**Apartment - Flats - Tenements 63**

**MANCHESTER** - Deluxe two bedroom, split level, private entrance, full appliances, 1 1/2 baths, carpet, full basement. \$285 per month. Paul W. Dougan, Realtor, 645-4535.

**MANCHESTER** - New two bedroom first floor apartment. Includes heat, appliances, carpet, \$180 per month. Paul W. Dougan, Realtor, 645-4535.

**LOOKING for anything in real estate rental - apartments, homes, multiple dwellings, no garage, walk to school, bus, etc. Call J. D. Real Estate Associates, Inc., 645-5119.**

**TWO-BEDROOM apartment**, 4 family home, children accepted, \$115. J.D. Real Estate, 645-5119.

**THREE - room heated apartment**, second floor, stove, refrigerator, near bus line, no pets. Available February 1st, after 5 p.m., 645-1008.

**MANCHESTER** - Main Street, small shop, central floor, heat, all appliances, 2 air-conditioning, heat and hot water included, garage, walk-to-school, available. References required. Call 645-0256 anytime.

**SIX very large sunny rooms**, second floor, walk to school, connections, \$175. 645-0514 mornings or evenings.

**MANCHESTER** - Deluxe duplex, two bedrooms, full private bathroom, heat, carpets, appliances included. \$220 per month. Paul W. Dougan, Realtor, 645-4535.

**FEMALE roommate wanted** to share apartment with same. 407-7709, 645-9127.

**FREE CHECKING SERVICE** to our Gold Card Senior Citizens.

**Open Saturday 9 - 11 Noon** for your convenience

**MARI-MADS**  
601 MAIN STREET  
MANCHESTER

**STATE**  
Offers Reduced Admissions to Senior Citizens on all film programs.

Enjoy Yourself - Get Out To See A Movie

**Business Locations For Rent 64**

**COMMERCIAL** place for lease, or sale. Excellent business location with building. Call 645-925, 645-926.

**FIRST FLOOR office space**, centrally located, parking, \$60 monthly. 643-1111.

**160 NORTH MAIN**, Manchester's newest and most prestigious office building. Approx. 1500 square feet of office space ready to go. Plenty of parking. Available February 1st, after 5 p.m., 645-1008.

**MANCHESTER** - Main Street, small shop, central floor, heat, all appliances, 2 air-conditioning, heat and hot water included, garage, walk-to-school, available. References required. Call 645-0256 anytime.

**SIX very large sunny rooms**, second floor, walk to school, connections, \$175. 645-0514 mornings or evenings.

**MANCHESTER** - Deluxe duplex, two bedrooms, full private bathroom, heat, carpets, appliances included. \$220 per month. Paul W. Dougan, Realtor, 645-4535.

**FEMALE roommate wanted** to share apartment with same. 407-7709, 645-9127.

**FREE CHECKING SERVICE** to our Gold Card Senior Citizens.

**Open Saturday 9 - 11 Noon** for your convenience

**MARI-MADS**  
601 MAIN STREET  
MANCHESTER

**STATE**  
Offers Reduced Admissions to Senior Citizens on all film programs.

Enjoy Yourself - Get Out To See A Movie

**STOP READING**  
When you finish this Large 5-room cape, approximately 3 acres. Fireplace, garage, VA assumable mortgage. Low down payment. Call 645-9127.

**COLONIAL-Style residential area**, completely redecorated, new fully equipped kitchen, formal dining room, living room with fireplace, full air-conditioning. Beautifully landscaped grounds.

**CAPE-3 rooms and enclosed porch**, 2 baths, 2-car garage, \$23,900.

**BOULDER RD.** - Private on over 1/4 acre. Custom Colonial, 2-car garage.

**MANCHESTER** - Investment property for rent. \$4,000 yearly. Asking \$49,500.

**PRESTIGE**  
Porter St. Immaculate Colonial Cape style home with walk to school, 1 1/2 baths, garage. All situated on a beautiful tree lined street. Call 645-9127.

**MANCHESTER** - Large, plush living room, dining room, 2 1/2 baths, 2-car garage, large fireplace family room, large living room, 2-car garage, \$46,700.

**MANCHESTER** - Spacious 6 room home, Bowers school, new roof, new furnace, garage, 2 1/2 baths, 2-car garage, \$46,000.

**WARANOKER RD.** - Custom built Cape in ideal location. Drive by, our sign is on the property. T. J. Crockett, Realtor, 645-9127.

**PARK-LIKE**  
Surroundings on this newer 3 room Cape in ideal location. Condition of this home has a central ceiling living room, full kitchen, dining room, walk-up attic, 3 bedrooms, half bath, family room, formal dining room, 2 1/2 baths, 2-car garage, aluminum siding, new roof, new furnace, \$46,000. All year occupancy. Only \$45,900.

**MANCHESTER** - Many features of 8 room Colonial with 3 bedrooms or more, huge living room, formal dining room, heated sunroom, ideal home and office combination, 400 sq. ft. finished basement, \$48,281.

**MANCHESTER** - 6 room Bungalow, just redecorated, new bath, garage, excellent location, Bowers school. Won't last at \$21,500.

**FRECHETTE & MARTIN REALTORS**  
647-9998

**MANCHESTER** - Many features of 8 room Colonial with 3 bedrooms or more, huge living room, formal dining room, heated sunroom, ideal home and office combination, 400 sq. ft. finished basement, \$48,281.

**MANCHESTER** - 6 room Bungalow, just redecorated, new bath, garage, excellent location, Bowers school. Won't last at \$21,500.

**FRECHETTE & MARTIN REALTORS**  
647-9998

**MANCHESTER** - Many features of 8 room Colonial with 3 bedrooms or more, huge living room, formal dining room, heated sunroom, ideal home and office combination, 400 sq. ft. finished basement, \$48,281.

**MANCHESTER** - 6 room Bungalow, just redecorated, new bath, garage, excellent location, Bowers school. Won't last at \$21,500.

**FRECHETTE & MARTIN REALTORS**  
647-9998

**Houses For Sale 72**

**FOREST HILLS** - 6 room Raised Ranch, Aluminum siding, three bedrooms, two full baths, formal living room with fireplace, dining room, rustic family room with old brick fireplace wall. Beautifully landscaped wooded lot. Owner, 645-9270.

**EASY TO OWN DUPLEXES**  
With \$4,000 down to qualified buyers you can own a 5 1/2 duplex. Each side consists of 2 bedrooms, 1 1/2 baths, stove, stained woodwork, separate driveways, central air conditioning, basements with 1 1/2 washer hookups and halfbaths. Ideal for 2 party ownership. Call early. Occupancy February 1st.

**FRECHETTE & MARTIN REALTORS**  
647-9998

**MANCHESTER** - Two-family residence C noted, aluminum siding, investment, or starter home. \$38,500. Flano Agency, 646-2677.

**NEW LISTING**  
Manchester - 7 room Ranch, spacious living room, 3 good sized bedrooms, separate dining room, dining room and kitchen, attached garage, fireplace, carpeting, appliances, screened porch. Convenient location, city utilities. \$31,900.

**U & R REALTY CO. INC.**  
643-2692  
Robert D. Murdoch, Realtor

**PRESTIGE**  
Porter St. Immaculate Colonial Cape style home with walk to school, 1 1/2 baths, garage. All situated on a beautiful tree lined street. Call 645-9127.

**MANCHESTER** - Large, plush living room, dining room, 2 1/2 baths, 2-car garage, large fireplace family room, large living room, 2-car garage, \$46,700.

**MANCHESTER** - Spacious 6 room home, Bowers school, new roof, new furnace, garage, 2 1/2 baths, 2-car garage, \$46,000.

**WARANOKER RD.** - Custom built Cape in ideal location. Drive by, our sign is on the property. T. J. Crockett, Realtor, 645-9127.

**PARK-LIKE**  
Surroundings on this newer 3 room Cape in ideal location. Condition of this home has a central ceiling living room, full kitchen, dining room, walk-up attic, 3 bedrooms, half bath, family room, formal dining room, 2 1/2 baths, 2-car garage, aluminum siding, new roof, new furnace, \$46,000. All year occupancy. Only \$45,900.

**MANCHESTER** - Many features of 8 room Colonial with 3 bedrooms or more, huge living room, formal dining room, heated sunroom, ideal home and office combination, 400 sq. ft. finished basement, \$48,281.

**MANCHESTER** - 6 room Bungalow, just redecorated, new bath, garage, excellent location, Bowers school. Won't last at \$21,500.

**FRECHETTE & MARTIN REALTORS**  
647-9998

**MANCHESTER** - Many features of 8 room Colonial with 3 bedrooms or more, huge living room, formal dining room, heated sunroom, ideal home and office combination, 400 sq. ft. finished basement, \$48,281.

**MANCHESTER** - 6 room Bungalow, just redecorated, new bath, garage, excellent location, Bowers school. Won't last at \$21,500.

**FRECHETTE & MARTIN REALTORS**  
647-9998

**Out of Town For Rent 66**

**HEBURN** - Wall St. 4 room heated apartment including hot water, carpeting, appliances, storage, laundry, parking, \$180 monthly. 645-2871, 645-0882.

**EAST HARTFORD** - Adult couple, no children, pets, four rooms, heat, hot water, stove, refrigerator. Near store and bus stop. Call 625-0988, Monday through Friday, 9 to 9 p.m., weekends 10 a.m. - 9 p.m., 645-1877.

**ROCKVILLE** - Rockland Terrace Apartments - Large and beautiful 3 and 4 room apartments include heat, hot water, all appliances, with dishwasher, disposal, carpeting, pool and your own private terrace in a country setting. From \$180. 800 no pets, 375-4956, 328-9058.

**ROCKVILLE** - Three rooms, furnished, utilities included. Large yard, quiet neighborhood, \$200 weekly. 375-9209, 730 - 9:30 p.m.

**BOLTON SUMMIT Apartments** - country living of Route 44-A, Lake Tolland Rd., 4000 sq. ft. Meadow to Sunset Rd., one-bedroom luxury apartment featuring carpeting, private hot water, appliances, beamed ceiling, paneled living room, air-conditioning optional, private full basement, convenient to center, \$160. Individual electric heating. Built by Archambault Builders, 645-1440, 647-1302.

**BOLTON** - Manchester town line, 3-room apartment, 1st floor, references required. \$185 monthly. 643-0963.

**ROCKVILLE** - 3 1/2 room apartment, stove, refrigerator and heat. Adult couple. No pets. Security. \$120 monthly. 645-454.

**ROCKVILLE** - Well kept four bedroom, brick income. Central location. \$44,000. For further information call, 645-9278.

**WOODLAND MANOR APARTMENTS**

1, 2 and 3-bedroom luxury apartments. Features walk-to-school, carpeting, vanity, 1 1/2 baths, built-in oven, range, dishwasher, refrigerator and disposal, electric heat, 2 air-conditioners, glass sliding doors, all large rooms. Full basement storage area, ample parking. Starting at \$175. Model apartment open for inspection 10:30 Saturday and 10:30 Sunday by appointment.

Built by **U & R Housing Corp.**

Rentals by Robert D. Murdoch, 645-9252, 645-9261, 645-9250

**Investment Property For Sale 70-A**

**COVENTRY** - 6 family, 4 rooms each unit, appliances, and fireplace, 4 acres of land, high rent. Amedy Realty, Realtors, 875-6283.

**ROCKVILLE** - Well kept four bedroom, brick income. Central location. \$44,000. For further information call, 645-9278.

**Land For Sale 71**

**HEBURN** - Millstream Park, two acre homestead in established neighborhood. \$8,300. Gerald Cross, Realtor, 228-0055, 228-9001.

**EASTFORD** - Unusual 1/4 acre, set up for mobile home. Will make excellent home lot. Small orchard, hard pasture, 1,000 gallon septic tank, well, 3634' driveway with paved driveway. \$19,800. Exclusive. Three Handerson, 645-9250. Evans & Clapp, Realtors, M.L.A. 647-1464.

**Stretch Your Dollars in "TOLLAND TOWNE"**

**YOU'RE INVITED**  
SUNDAY, 2-5 P.M.

Brand new homes in Manchester proper with delightful rural settings. Pick your home on your lot or choose your own decorations on several now under construction.

**NUTMEG HOMES, INC.** - has a well earned reputation for quality of construction and excellence of design. We invite comparison for size and quality! Our sales are good come see why.

**OPENINGS:** Two lots on Vernon St. past Book Dr. Take next lot on Richmond Rd. Right at end of Richmond Rd. on Kennedy Rd. Look for signs on Kennedy Rd. and Woodstock Dr.

**MANCHESTER** - New one-bedroom duplex includes heat, appliances, carpets, air-conditioning. Full basement. \$198 per month. Paul W. Dougan, Realtor, 645-4535.

**TWO-BEDROOM town house** apartment, carpeted living room, eat-in kitchen with appliances, 1 1/2 baths full bathroom with washer and dryer hook-up, convenient location, \$180 per month. Call 645-2529, 644-8890.

**Mediterranean 7-room Raised Ranch**, Built-in, 1 1/2 baths, fireplace, garage, 3/4 acre private wooded lot. \$39,100. Four other models to choose from. Prices range from \$25,900 to \$31,900.

**AMEDY REALTY - 675-6293**  
**D. W. FISH REALTY - 872-9153**  
Eric S. Babin - Builder and Developer

**Furnished Apartments 63-A**

**THREE-ROOM** bachelor apartment, split level, private entrance, all appliances included, TV, parking. Middle-age working person. Call 645-1877, after 1 p.m.

**MANCHESTER** - 4-5 two family remodeled kitchens and baths. Fireplace, large lot. Garage. Volcott Realtors, 645-8200.

**MANCHESTER** - Large oversized Ranch built for the quality minded executive now must be sold. Located near East Hartford, this young Ranch offers 3 large bedrooms, 2 full baths, 2-car garage and oil, yes, a gorgeous family room. Call for more details.

**FRECHETTE & MARTIN REALTORS**  
647-9998

**MANCHESTER** - Attention gentleman farmer, 8-room custom built Colonial-Cape, 2 acres of land, 2 buildings. Hayes Agency, 646-0181.

**STOP READING**  
When you finish this Large 5-room cape, approximately 3 acres. Fireplace, garage, VA assumable mortgage. Low down payment. Call 645-9127.

**COLONIAL-Style residential area**, completely redecorated, new fully equipped kitchen, formal dining room, living room with fireplace, full air-conditioning. Beautifully landscaped grounds.

**CAPE-3 rooms and enclosed porch**, 2 baths, 2-car garage, \$23,900.

**BOULDER RD.** - Private on over 1/4 acre. Custom Colonial, 2-car garage.

**MANCHESTER** - Investment property for rent. \$4,000 yearly. Asking \$49,500.

**PRESTIGE**  
Porter St. Immaculate Colonial Cape style home with walk to school, 1 1/2 baths, garage. All situated on a beautiful tree lined street. Call 645-9127.

**MANCHESTER** - Large, plush living room, dining room, 2 1/2 baths, 2-car garage, large fireplace family room, large living room, 2-car garage, \$46,700.

**MANCHESTER** - Spacious 6 room home, Bowers school, new roof, new furnace, garage, 2 1/2 baths, 2-car garage, \$46,000.

**WARANOKER RD.** - Custom built Cape in ideal location. Drive by, our sign is on the property. T. J. Crockett, Realtor, 645-9127.

**PARK-LIKE**  
Surroundings on this newer 3 room Cape in ideal location. Condition of this home has a central ceiling living room, full kitchen, dining room, walk-up attic, 3 bedrooms, half bath, family room, formal dining room, 2 1/2 baths, 2-car garage, aluminum siding, new roof, new furnace, \$46,000. All year occupancy. Only \$45,900.

**MANCHESTER** - Many features of 8 room Colonial with 3 bedrooms or more, huge living room, formal dining room, heated sunroom, ideal home and office combination, 400 sq. ft. finished basement, \$48,281.

**MANCHESTER** - 6 room Bungalow, just redecorated, new bath, garage, excellent location, Bowers school. Won't last at \$21,500.

**FRECHETTE & MARTIN REALTORS**  
647-9998

**MANCHESTER** - Many features of 8 room Colonial with 3 bedrooms or more, huge living room, formal dining room, heated sunroom, ideal home and office combination, 400 sq. ft. finished basement, \$48,281.

**MANCHESTER** - 6 room Bungalow, just redecorated, new bath, garage, excellent location, Bowers school. Won't last at \$21,500.

**FRECHETTE & MARTIN REALTORS**  
647-9998

**Business Locations For Rent 64**

**COMMERCIAL** place for lease, or sale. Excellent business location with building. Call 645-925, 645-926.

**FIRST FLOOR office space**, centrally located, parking, \$60 monthly. 643-1111.

**160 NORTH MAIN**, Manchester's newest and most prestigious office building. Approx. 1500 square feet of office space ready to go. Plenty of parking. Available February 1st, after 5 p.m., 645-1008.

**MANCHESTER** - Main Street, small shop, central floor, heat, all appliances, 2 air-conditioning, heat and hot water included, garage, walk-to-school, available. References required. Call 645-0256 anytime.

**SIX very large sunny rooms**, second floor, walk to school, connections, \$175. 645-0514 mornings or evenings.

**MANCHESTER** - Deluxe duplex, two bedrooms, full private bathroom, heat, carpets, appliances included. \$220 per month. Paul W. Dougan, Realtor, 645-4535.

**FEMALE roommate wanted** to share apartment with same. 407-7709, 645-9127.

**FREE CHECKING SERVICE** to our Gold Card Senior Citizens.

**Open Saturday 9 - 11 Noon** for your convenience

**MARI-MADS**  
601 MAIN STREET  
MANCHESTER

**STATE**  
Offers Reduced Admissions to Senior Citizens on all film programs.

Enjoy Yourself - Get Out To See A Movie

**STOP READING**  
When you finish this Large 5-room cape, approximately 3 acres. Fireplace, garage, VA assumable mortgage. Low down payment. Call 645-9127.

**COLONIAL-Style residential area**, completely redecorated, new fully equipped kitchen, formal dining room, living room with fireplace, full air-conditioning. Beautifully landscaped grounds.

**CAPE-3 rooms and enclosed porch**, 2 baths, 2-car garage, \$23,900.

**BOULDER RD.** - Private on over 1/4 acre. Custom Colonial, 2-car garage.

**MANCHESTER** - Investment property for rent. \$4,000 yearly. Asking \$49,500.

**PRESTIGE**  
Porter St. Immaculate Colonial Cape style home with walk to school, 1 1/2 baths, garage. All situated on a beautiful tree lined street. Call 645-9127.

**MANCHESTER** - Large, plush living room, dining room, 2 1/2 baths, 2-car garage, large fireplace family room, large living room, 2-car garage, \$46,700.

**MANCHESTER** - Spacious 6 room home, Bowers school, new roof, new furnace, garage, 2 1/2 baths, 2-car garage, \$46,000.

**WARANOKER RD.** - Custom built Cape in ideal location. Drive by, our sign is on the property. T. J. Crockett, Realtor, 645-9127.

**PARK-LIKE**  
Surroundings on this newer 3 room Cape in ideal location. Condition of this home has a central ceiling living room, full kitchen, dining room, walk-up attic, 3 bedrooms, half bath, family room, formal dining room, 2 1/2 baths, 2-car garage, aluminum siding, new roof, new furnace, \$46,000. All year occupancy. Only \$45,900.

**MANCHESTER** - Many features of 8 room Colonial with 3 bedrooms or more, huge living room, formal dining room, heated sunroom, ideal home and office combination, 400 sq. ft. finished basement, \$48,281.

**MANCHESTER** - 6 room Bungalow, just redecorated, new bath, garage, excellent location, Bowers school. Won't last at \$21,500.

**FRECHETTE & MARTIN REALTORS**  
647-9998

**MANCHESTER** - Many features of 8 room Colonial with 3 bedrooms or more, huge living room, formal dining room, heated sunroom, ideal home and office combination, 400 sq. ft. finished basement, \$48,281.

**MANCHESTER** - 6 room Bungalow, just redecorated, new bath, garage, excellent location, Bowers school. Won't last at \$21,500.

**FRECHETTE & MARTIN REALTORS**  
647-9998

**PHILBRICK AGENCY REALTORS**  
646-4200

**MANCHESTER** - Many features of 8 room Colonial with 3 bedrooms or more, huge living room, formal dining room, heated sunroom, ideal home and office combination, 400 sq. ft. finished basement, \$48,281.

**MANCHESTER** - 6 room Bungalow, just redecorated, new bath, garage, excellent location, Bowers school. Won't last at \$21,500.

**FRECHETTE & MARTIN REALTORS**  
647-9998

**MANCHESTER** - Many features of 8 room Colonial with 3 bedrooms or more, huge living room, formal dining room, heated sunroom, ideal home and office combination, 400 sq. ft. finished basement, \$48,281.

**MANCHESTER** - 6 room Bungalow, just redecorated, new bath, garage, excellent location, Bowers school. Won't last at \$21,500.

**FRECHETTE & MARTIN REALTORS**  
647-9998

**Houses For Rent 65**

**VERNON** - 5-room house for lease, 3 bedrooms, new kitchen, 2 baths, garage, security, references. \$280 monthly. Hayes Agency, 646-0181.

**Out of Town For Rent 66**

**HEBURN** - Wall St. 4 room heated apartment including hot water, carpeting, appliances, storage, laundry, parking, \$180 monthly. 645-2871, 645-0882.

**EAST HARTFORD** - Adult couple, no children, pets, four rooms, heat, hot water, stove, refrigerator. Near store and bus stop. Call 625-0988, Monday through Friday, 9 to 9 p.m., weekends 10 a.m. - 9 p.m., 645-1877.

**ROCKVILLE** - Rockland Terrace Apartments - Large and beautiful 3 and 4 room apartments include heat, hot water, all appliances, with dishwasher, disposal, carpeting, pool and your own private terrace in a country setting. From \$180. 800 no pets, 375-4956, 328-9058.

**ROCKVILLE** - Three rooms, furnished, utilities included. Large yard, quiet neighborhood, \$200 weekly. 375-9209, 730 - 9:30 p.m.

**BOLTON SUMMIT Apartments** - country living of Route 44-A, Lake Tolland Rd., 4000 sq. ft. Meadow to Sunset Rd., one-bedroom luxury apartment featuring carpeting, private hot water, appliances, beamed ceiling, paneled living room, air-conditioning optional, private full basement, convenient to center, \$160. Individual electric heating. Built by Archambault Builders, 645-1440, 647-1302.

**BOLTON** - Manchester town line, 3-room apartment, 1st floor, references required. \$185 monthly. 643-0963.

**ROCKVILLE** - 3 1/2 room apartment, stove, refrigerator and heat. Adult couple. No pets. Security. \$120 monthly. 645-454.

**ROCKVILLE** - Well kept four bedroom, brick income. Central location. \$44,000. For further information call, 645-9278.

**WOODLAND MANOR APARTMENTS**

1, 2 and 3-bedroom luxury apartments. Features walk-to-school, carpeting, vanity, 1 1/2 baths, built-in oven, range, dishwasher, refrigerator and disposal, electric heat, 2 air-conditioners, glass sliding doors, all large rooms. Full basement storage area, ample parking. Starting at \$175. Model apartment open for inspection 10:30 Saturday and 10:30 Sunday by appointment.

Built by **U & R Housing Corp.**

Rentals by Robert D. Murdoch, 645-9252, 645-9261, 645-9250

**Investment Property For Sale 70-A**

**COVENTRY** - 6 family, 4 rooms each unit, appliances, and fireplace, 4 acres of land, high rent. Amedy Realty, Realtors, 875-6283.

**ROCKVILLE** - Well kept four bedroom, brick income. Central location. \$44,000. For further information call, 645-9278.

**Land For Sale 71**

**HEBURN** - Millstream Park, two acre homestead in established neighborhood. \$8,300. Gerald Cross, Realtor, 228-0055, 228-9001.

**EASTFORD** - Unusual 1/4 acre, set up for mobile home. Will make excellent home lot. Small orchard, hard pasture, 1,000 gallon septic tank, well, 3634' driveway with paved driveway. \$19,800. Exclusive. Three Handerson, 645-9250. Evans & Clapp, Realtors, M.L.A. 647-1464.

**Stretch Your Dollars in "TOLLAND TOWNE"**

**YOU'RE INVITED**  
SUNDAY, 2-5 P.M.

Brand new homes in Manchester proper with delightful rural settings. Pick your home on your lot or choose your own decorations on several now under construction.

**NUTMEG HOMES, INC.** - has a well earned reputation for quality of construction and excellence of design. We invite comparison for size and quality! Our sales are good come see why.

**OPENINGS:** Two lots on Vernon St. past Book Dr. Take next lot on Richmond Rd. Right at end of Richmond Rd. on Kennedy Rd. Look for signs on Kennedy Rd. and Woodstock Dr.

**MANCHESTER** - New one-bedroom duplex includes heat, appliances, carpets, air-conditioning. Full basement. \$198 per month. Paul W. Dougan, Realtor, 645-4535.

**TWO-BEDROOM town house** apartment, carpeted living room, eat-in kitchen with appliances, 1 1/2 baths full bathroom with washer and dryer hook-up, convenient location, \$180 per month. Call 645-2529, 644-8890.

**Mediterranean 7-room Raised Ranch**, Built-in, 1 1/2 baths, fireplace, garage, 3/4 acre private wooded lot. \$39,100. Four other models to choose from. Prices range from \$25,900 to \$31,900.

**AMEDY REALTY - 675-6293**  
**D. W. FISH REALTY - 872-9153**  
Eric S. Babin - Builder and Developer

**Houses For Sale 72**

**FOREST HILLS** - 6 room Raised Ranch, Aluminum siding, three bedrooms, two full baths, formal living room with fireplace, dining room, rustic family room with old brick fireplace wall. Beautifully landscaped wooded lot. Owner, 645-9270.

**EASY TO OWN DUPLEXES**  
With \$4,000 down to qualified buyers you can own a 5 1/2 duplex. Each side consists of 2 bedrooms, 1 1/2 baths, stove, stained woodwork, separate driveways, central air conditioning, basements with 1 1/2 washer hookups and halfbaths. Ideal for 2 party ownership. Call early. Occupancy February 1st.

**FRECHETTE & MARTIN REALTORS**  
647-9998

**MANCHESTER** - Two-family residence C noted, aluminum siding, investment, or starter home. \$38,500. Flano Agency, 646-2677.

**NEW LISTING**  
Manchester - 7 room Ranch, spacious living room, 3 good sized bedrooms, separate dining room, dining room and kitchen, attached garage, fireplace, carpeting, appliances, screened porch. Convenient location, city utilities. \$31,900.

**U & R REALTY CO. INC.**  
643-2692  
Robert D. Murdoch, Realtor

**PRESTIGE**  
Porter St. Immaculate Colonial Cape style home with walk to school, 1 1/2 baths, garage. All situated on a beautiful tree lined street. Call 645-9127.

**MANCHESTER** - Large, plush living room, dining room, 2 1/2 baths, 2-car garage, large fireplace family room, large living room, 2-car garage, \$46,700.

**MAN**



Obituary

I. William Hollander
I. William Hollander, 63, of 816 Center St. died suddenly last night at the Ramada Inn, Windsor Locks, while attending an installation dinner - meeting of Toastmasters International. He was the husband of Mrs. Mary Kullgowski Hollander.

Mr. Hollander was born in New London, son of the late Harry and Jennie Schaefer Hollander, and had lived in Manchester for the past 21 years. He was a graduate of New London schools and Tri-State University, Angola, Ind. He was employed as an engineer at Hamilton Standard Division of United Aircraft Corp., Windsor Locks.

He was a charter member and past district governor of Toastmasters International. He was a member of Friendship Lodge of Masons and a past advisor of the Pequot Council of Boy Scouts in New London.

Survivors, besides his wife, Ileana Aronson of Manchester and Mrs. George D'Amora of Vernon; a brother, Perry Hollander of New London; two sisters, Mrs. Samuel Rodensky of Woodstock and Mrs. Jack Molts of New London; and two grandchildren.

Funeral services will be Monday at the Weinstein Mortuary, 640 Farmington Ave., Hartford, at a time to be announced. Burial will be in East Cemetery. There are no calling hours.

The family suggests that any memorial contributions may be made to a charity of the donor's choice.

Alexander Balchunas
Alexander Balchunas, 66, of 88 Starkey St., maintenance superintendent of Colonial Board and Lydall-Foulds Divisions of Lydall Inc., died Thursday night at his home. He was the husband of Mrs. Claudia Glad Balchunas.

Mr. Balchunas was born June 30, 1915 in Manchester and had lived in Manchester all his life. He had been employed at the Manchester firm for 39 years. He was a communicant of St. Bridget Church and a member of the Rockville Lodge of Moose.

Survivors, besides his wife, are a daughter, Mrs. Charles J. Parla of Manchester; a stepson, Donald M. Savino of Scotland, Conn.; two brothers, Otto Balchunas of Manchester and Walter Balchunas of New York; a sister, Mrs. Clarence Koch of Windsor; and five grandchildren.

The funeral will be Monday at 8:15 a.m. from the Holmes Funeral Home, 400 Main St., with a Mass of the Resurrection at St. Bridget Church at 9. Burial will be in St. James Cemetery.

Friends may call at the funeral home tomorrow from 7 to 9 p.m.

Harold T. Marth
COVENTRY - Harold T. Marth 76, of Hartford, a Coventry native, died Thursday at Hartford Hospital. He was the husband of Mrs. Dorothy Ingham Marth.

Mr. Marth was born Jan. 22, 1896 in Coventry and had lived in Hartford for 49 years. Before he retired 10 years ago, he was employed as a foreman at the former Case, Lockwood and Brainard Printing Co., Hartford, for 40 years.

Survivors, besides his wife, are a daughter, Mrs. Helen Mandly of Manchester; a son, Russell Marth of Vernon; two sisters, Mrs. Betty March of Greenfield, Mass., and Mrs. Ralph Bishop of Miami, Fla.; and four grandchildren including Sandra Mandly and Kim Mandly of Manchester.

Funeral services will be Monday at 2 p.m. at Rose Hill Funeral Home, 580 Elm St., Rocky Hill. Burial will be in Rose Hill Memorial Park, Rocky Hill.

Friends may call at the funeral home tomorrow from 2 to 4 and 7 to 9 p.m.

Vernon Steele Talk On Congress Set Friday

Congressman Robert Steele will speak on "A Re-evaluation of Congress," at a community meeting to be sponsored by the Provisional League of Women Voters Friday at 8:15 p.m. at Sacred Heart Church hall, Rt. 30.

Steele, a Republican, is a resident of Vernon. He will discuss his observations on the work of Congress and its effectiveness. The local League of Women Voters has been studying the responsiveness of Congressional structures and procedures as one of its national study items.

Mrs. Lillian Emory is chairman of the study group. The public is invited to attend the meeting.

Nursing Visits
The Rockville Public Health Nursing Association made a total of 1,154 visits during December in the towns it serves, Vernon, Ellington, Tolland, Bolton and Somers. Of this total, 206 were for the purpose of administering bedside care and treatments and 940 were for health promotion.

Divided into towns, visits were as follows: Vernon 648; Tolland 185; Bolton 63; Ellington 156 and Somers 102.

Church Meeting
The First Evangelical Church of Rockville will hold its annual meeting Tuesday at 7:30 p.m. Committee chairmen will present reports on the activities of the past year, the budget for the coming year will be adopted and new church officers will be elected.

All confirmed members of the church are eligible to vote on all issues to come before this meeting. After the meeting, there will be a social hour in Fellowship Hall.

Pinocchio Group
Winners in the Tuesday session of the Vernon Senior Citizens' Pinocchio group were: Julia Vendrillo 70; Joe Kinman 70; Madeline Barrows 68; Alma Dittich 69; Gertrude Patric 68; Camille Pogue 69; Bill Rogalus 68 and Mary St. Louis 66.

Thursday tournament winners were: John Pogue 64; Ed Flechsig 60 and Vincent Barrows 58. Pinocchio will be played next Tuesday and Thursday at the Teen Center, Rt. 30 at 1:30 p.m.

Servicemen Graduated
Navy Firearm Apprentice William Fanchelli, son of Mr. and Mrs. Robert Fanchelli of 2 Glaston Dr., Rockville graduated from recruit training at the Naval Training Center, Great Lakes, Ill. A graduate of Rockville High School he is scheduled to report to Bollerman "A" School at the center.

Marine Pfc. David Ignatowicz, son of Mr. and Mrs. Peter Ignatowicz of 33 Vernon Ave., has reported for duty at the Marine Corps Helicopter Air Station, Jacksonville, N.C. He is a graduate of Rockville High School and joined the Marine Corps in June, 1971.

Connally Warns Nation's Labor On Cooperation
Connally addressed the final luncheon session of a two-day conference on American industrial competitiveness sponsored by the Conference Board, a business research organization.

In his Thursday address to a U.S. Chamber of Commerce gathering, Connally told businessmen, "When we end wage-and-price controls is going to depend on you. If you're not in a hurry, they're (the controls) going to be around for a long time."

In releasing his economic figures Friday, the Nixon administration said the December surge in the cost of living, due mainly to a 1.1 per cent increase in food prices, was encouragingly small but could continue for a few months and perhaps even get worse.

Mrs. Emma Ann Bickmore
Funeral services for Mrs. Emma Ann Bickmore of 81 Washington St., who died Thursday in Cambridge, Mass., will be Monday at 1 p.m. at the Holmes Funeral Home, 400 Main St. The Rev. Lyman Farrar, co-pastor of Center Congregational Church, will officiate. Burial will be in East Cemetery.

Friends may call at the funeral home tomorrow from 7 to 8 p.m.

Enemy Busy With Attacks Along Coast

provinces along the central coast. The most serious fighting was in Binh Dinh Province, long considered a Viet Cong stronghold.

Personal Notices

Card of Thanks
The family of James A. Carroll wish to extend their heartfelt thanks to their dear friends, relatives and neighbors for their understanding sympathy and many kindnesses during the recent bereavement in the loss of their beloved husband and father.

This test pattern is part of the Herald's quality printing control program to give you the nation's finest newspaper.



At The Center

by Glenn Gamber

An unusual request came through Town Manager Robert Weiss's office this month. The director of the Minneapolis St. Paul International Art Festival has extended an invitation to Weiss and people in your area to attend our art festival, starting May 27 through June 4, 1972.

The director has asked Weiss to extend invitations to local galleries, collectors, and artists to attend or display works at the festival to which "artists from all over the world are invited."

The festival will include fine arts, music, theater, dance and films. Anyone interested in writing for an application should contact Weiss's office.

Mulch Stockpiled
About five truckloads of wood chips were produced from the nearly 1,000 Christmas trees chipped Jan. 10 in a project sponsored by the Manchester Junior Women's Club. The mulch is being stored at the town landfill area on Olcott St. and will eventually be spread on town gardens.

In Orientation
Town Clerk Edward Tomkiel participated in an orientation program for newly elected town clerk's last Thursday at the State Capitol. The program was conducted in Secretary of the State Gloria Schaffer's office.

Praises Androlut
Would you believe this column is read as far away as Sarasota, Florida? Horace Murphy, former town park superintendent, read it and noticed the recent meeting scheduled to discuss cleaning up Center Springs Park. He sent Weiss a chronology of developments at the park and reminded him that Bill Androlut, work coordinator in the park department, has long been interested in the park. "Bill's heart has been in this park for a long time," Murphy said.

Androlut attended the meeting last Tuesday in the lodge at the park and was pointed out to residents around the park as one who has been concerned with the park. Hello down there in Sarasota!

Tax Collections
Ernest Machell, town collector of revenue, reports that 67.9 per cent of the town's property taxes had been collected by the end of December. This is a total of \$8,180,837.

Last year at this time, only 65.7 per cent or about \$7,557,409 in property taxes had been collected by Dec. 31. The General Fund stood at \$9,770,381 or 87 per cent at the end of last month. Last year at the same time, \$8,999,138 or 86 per cent of the General Fund was in.

The Water Fund had \$401,968 in it by Dec. 31 or 68.1 per cent of its anticipated total. The Sewer Fund was at \$290,088 or 41 per cent of its expected level. The Fire District Fund was at 65 per cent Dec. 31 with \$674,888. The Special Taxing District's collections were at \$19,694 or 50.8 per cent.

Find the Site
An unsolicited remark - If you have nothing to do sometime, you might try and locate the Manchester Recreation Center, formerly an Army Nike Site. It is in the southwest corner of town off Garden Grove Dr. which is off Keeney St.

If the renovations of the many buildings there are as successful as the renovation of the Teen Center, a building there scheduled to open Friday night, then the Manchester Recreation Center will be one of the most used and talked about facilities since Charter Oak Park.

Much of the work so far was done with town funds and by volunteers from Brotherhood in Action and the Youth Commission. The work is being coordinated by John Harkins, assistant town manager.

made at this time toward the concept of year-round schooling by either the subcommittee or the Board of Education.

Cub Scout Party
Cub Scout Pack 915 will hold a Winter Wonderland skating party Sunday at 1 at Morey's Pond in Ashford.

The Scouts will bring their own ice skates and, if there is snow, sleds and toboggans. An ice fishing demonstration will be held and snowmobile rides provided along with hot chocolate and marshmallows.

Receives Certificate
At a staff meeting this week, Walter Senkow, town engineer, was presented a Certificate of Recognition from the University of Connecticut's Institute of Public Service for his participation in a course entitled "Case Studies of Topics and Urban Systems Program."

Both Topics and Urban Systems are federal programs for the improvement of roads and traffic regulation.

The town has been authorized to begin a \$38,000 study of its traffic situation under the Topics program. According to Weiss, the town will also apply for funds for road improvements under the Urban Systems program when money becomes available.

Union Pond
Union Pond has slipped from the news and until the spring will probably not be talked about too much.

Repairs to the dam have progressed and William O'Neill, director of public works, expects that three more weeks work, probably in April, will complete the job. Penetrin Systems Inc. of Everett, Mass. is making the dam repairs.

O'Neill also anticipates grading and seeding an area at the southern tip of the pond for use as a boat launching area before the pond is filled back up sometime in May.

Dredging of a channel in the southern end of the pond and construction of a skating area there has been completed.

Tolland
Academic Skills Taught Via Arts, Crafts Projects
The Learning Disabilities class at the Middle School revolves around an industrial arts and crafts approach as an alternative to the "failure syndrome" experienced by the students in a regular classroom situation.

The specially funded program has been developed by LD teacher John Campbell, who described the details in a special report presented recently to the Board of Education.

The class includes children between the ages of 10 and 15 "who have demonstrated a definite inability to learn in the normal classroom setting," Campbell said. "School to them has been a series of failures; an ego crushing experience."

Campbell has concentrated on developing ways to restore the student's self confidence.

Students design and construct projects which are then taken home, sold to the public or displayed in the school showcase.

While the ultimate goal sounds simple, its effects are far reaching in the benefits to the student.

Before the project can be completed the student has been instructed in basic skill areas such as math, reading, science and social studies as they relate to the project he is working on.

The student tries hard to accomplish the necessary skills since he is involved in an activity he enjoys and can become successful at. The skills are also presented in a more meaningful context for the learning disabilities child...he can see why he must conquer the immediate skill to obtain the final result.

In addition to the basic study skills, the student learns to develop motor skills, such as using tools, various types of finishing materials, painting and other activities necessary

Bolton Group Plans Single Gals' Social Club

Initial plans are under way to form a woman's social club in Bolton which would be geared to serving the needs of single women in the community who are neither Junior Women nor senior citizens. Single women, widows, and even married women who want an occasional "night out with the girls" are welcome to join the group.

Present plans call for activities to include theater and dinner parties, fashion shows and day trips. Other ideas for activities and programs will be discussed at the first organizational meeting to be held tomorrow at 7:30 p.m. at St. George's Church on Rt. 44A. Refreshments will be served.

Ecumenical Endeavors
To emphasize the Octave of Prayer for Christian Unity currently being celebrated throughout the state, Rev. David Campbell of United Methodist Church will exchange pulpits tomorrow with Rev. Walter Loomis of Community Baptist in Manchester.

Tomorrow evening an ecumenical potluck supper and program for all Bolton families will be held at St. George's Episcopal Church at 8 p.m.

Two films dealing with ecumenical developments will be shown and discussed after supper. A special film will be shown for children during the adult program. Nursery care will be provided.

Those planning to attend are asked to bring a casserole, salad or dessert as well as their own dishes and silverware.

Seniors Social
Bolton's Senior Citizens will meet Wednesday at 1:30 p.m. at Community Hall for an afternoon of card playing. There will be no business meeting. If enough interest is shown, the group plans to have card socials the fourth Wednesday of each month, while continuing to hold the regular business and social meeting on the second Wednesday of each month.

First Aid
An advance Red Cross first aid course will not be offered to Bolton residents this winter, according to Mrs. Debra Vine, chairman of the Junior Women's Club public affairs committee which usually sponsors the course.

Mrs. Vine notes that an advanced instruction program may be offered in the fall, and advises that anyone wishing to take the course before then should contact the Manchester Red Cross office.

Tax Review
Bolton's Board of Tax Review will be in session next month to hear complaints from persons aggrieved by their assessment. Meetings at Community Hall will be Feb. 2 and Feb. 4 from 7 to 9 p.m. and Feb. 5 from 9 a.m. to noon.

Sitting on the chair will be Allan Hoffman, chairman, Abilio Santos, and Olaf Erlanson.

Firemen's Ball
Initial plans are being made for the annual Firemen's Ball. This year's affair will be held at Kosciuszko Club in Rockville from 7 p.m. to 1 a.m. and will feature a roast beef dinner.

Music for dancing will be provided by Maurice Bergeron's orchestra. Persons attending may bring their own liquor and set-ups will be provided. Tickets will be available soon.

Manchester Evening Herald Bolton correspondent Judith Donohue, tel. 649-8409.

Center Church Adopts Budget, Honors Simpson

Rev. Clifford O. Simpson, minister of Center Congregational Church for 27 years, was named pastor emeritus last night at the church's 138th Financial Annual Meeting. The honor will be officially bestowed March 19 at a workshop scheduled for 9:15 a.m. The Rev. Mr. Simpson recently retired.

A budget of \$102,900 was adopted at last night's meeting with about 15 per cent of it to be used in the outreach of the church's mission and social action through both the Manchester Council of Churches and the Connecticut Conference of the United Church of Christ.

At the meeting the church voted to join the Greater Hartford Council of Churches.

Duplicate Bridge

Results last night in a duplicate bridge game at the Italian-American Club are: North-South; Robert Stratton and Mrs. Lawrence Fagan, first; Robert Hughes and James Baker, second; Donald Conwell and Mike Maguire, third.

Also, East-West: Mrs. W. L. Holland and Joseph Toce, first; John Descy and Thomas Hyde, second; Mrs. Peg LaPlant and Ed Conway, third.

The game, sponsored by the Manchester Bridge Club, is played each Friday at 8 p.m. at the clubhouse, 135 Eldridge St.

Results last night in a duplicate bridge game sponsored by the Andover Bridge Club at Andover Congregational Church are: Mrs. Samuel Pierson and Mrs. Suzanne Shortz, first; Mr. and Mrs. Donald Weeks and Mrs. Florence Smyth and Bill Radzewicz, tied for second.

Results in a Thursday morning duplicate bridge game at the Manchester Country Club are: North-South; Mrs. Maury Brown and Mrs. Phillip Holway, first; Mrs. George Zaikan and Mrs. Ethel Coon, second; Miss Hazel Anderson and Mrs. Louise Comstock, third.

Also, East-West: Mrs. T. J. Crockett and Mrs. Leslie Williamson, first; Mrs. Arthur Smith and Mrs. Leland Carlson, second; an Mr. and Mrs. Herbert Smith, third.

The game next Thursday will be played at 9:30 a.m. at the home of Mrs. Maury Brown, 484 Porter St.

Results in a Wednesday morning duplicate bridge game at the Community Y are: Mrs. Howard Boyd and Mrs. R. B. Wadsworth, first; Mrs. John Boyle and Mrs. James McLaughlin, second; Mrs. Roy Warren and Mrs. Charles Launi, third.

Results in a Tuesday evening South Windsor Bridge Club duplicate bridge game are: P.D. Griffiths and Charles Smith, first; Mr. and Mrs. Richard Kibbe, second; Mrs. Howard Boyd and Robert Hughes, third.

"No Miracle But Love," a documentary on mental retardation at Bethesda in Watertown, Wis., will be shown tomorrow at 12:30 p.m. on Channel 30. Zion Evangelical Lutheran Church during a three-year period has contributed \$5,000 to an expansion program at Bethesda and two similar institutions.

The Rev. Walter Loomis, pastor of Community Baptist Church, will conduct a service tomorrow at 2 p.m. at Green Lodge. He will be assisted by Mrs. Nicholas Derewianka.

Members of the American Legion Auxiliary will meet tomorrow at 7:30 p.m. at the Holmes Funeral Home, 400 Main St., to pay respects to the late Mrs. Emma Bickmore, a past president of the unit.

Emanuel Lutheran Church will have its annual meeting and election of officers tomorrow at 2 p.m. in Luther Hall of the church. Resolutions, proposals and a budget for 1972 will be presented. Refreshments will be served by a committee of the Emanuel Lutheran Church Women during a fellowship hour.

The Junior Choir of Community Baptist Church will rehearse tomorrow at 6:30 p.m. at the church.

The Confirmation Class of South United Methodist Church will meet Monday at 2:15 and 3:45 p.m. in Cooper Hall of the church.

The Perennial Planters Garden Club will meet Monday at 8 p.m. at the home of Mrs. Theodore Chambers, 41 White St. Mrs. Chambers will speak on "Indoor Gardening." Miss Helen Jamroga will be co-hostess. Members are asked to present their sketches for the public garden at Munro Parklet.

Presidential Primary??

after July 1. Mrs. Schaffer only wanted to ban absentee balloting in the town committee primaries.

The problem is that reapportionment of the General Assembly has complicated the electoral process this year, and there is not enough time between the nomination of town committees and the primaries to get out absentee ballots, Mrs. Schaffer said.

Air Piracy Charges Due In Hijacking

(Continued from Page One)
ment and observation of injuries. The FBI identified LaPoint Friday as the man who carried an incendiary device aboard an Airwest DC9 jet in Las Vegas, Nev., Thursday and forced the crew to fly east over the Rockies.

He bailed out near Akron and Sterling with \$50,000 in \$10 and \$20 bills in airline ransom but was spotted by trailing Air Force F111 jets which radioed his location. He was captured on the ground in less than three hours. The airliner landed in Denver.

New England officials said LaPoint had been in trouble with the law previously. Seabrook Police Chief Raymond F. Perkins said LaPoint was convicted in District Court at Amesbury, Mass., last October for car theft and was sentenced to 180 days in jail. He is free on bail pending an appeal.

LaPoint also has been captured with various motor vehicle and narcotics violations, Perkins said.

Echoes of Talk By President

(Continued from Page One)
in this country" and challenged the Alabama governor to a television debate. Both men are campaigning for Florida's March 14 Democratic presidential primary.

Sen. Hubert H. Humphrey of Minnesota took a verbal swipe at Muskie's strategy of winning big-name endorsements, saying he is "a big enough shot myself" to campaign for the presidency on his own. The former vice president, who ran unsuccessfully against Nixon in 1968, spoke in Washington before the national board of the predominantly black National Alliance of Postal and Federal Employees.

Sen. George McGovern of South Dakota, in a visit to a black nursing home in St. Petersburg, Fla., criticized the budget priorities outlined in Nixon's State of the Union message, saying more money should be spent on welfare and to provide more jobs instead of defense.

"Government has to be more compassionate and more sensitive to the problems of disadvantaged people," he said.

Nation Has Flu; But Not Bad

(Continued from Page One)
principals and assistant principals had to teach classes. In Cincinnati, Ohio, officials said absences among pupils were about normal but the rate for teachers was double at 10 per cent.

Perry Central High School in Leopold, Ind., was closed this week after 280 pupils stayed home with flu. The school's basketball game Friday night was postponed because only one player was not sick.

In Ripley County, Ind., where there have been 800 cases of flu each week this month, Dr. Charles L. Barrett, a state epidemiologist, advised the schools not to close because it would prevent young people from gathering and spreading the disease.

Twenty-five Maryland schools have closed during the past two weeks because of flu outbreaks. But as in many cities where pupils have been ill, there has been no significant absentee rate among workers.

Rockville Hospital Notes

Visiting hours are 12:30 to 5 p.m. in all areas except maternity where they are 9 to 4 and 6:30 to 9 p.m.

Admitted Thursday: Brenda Sauter, N. Park St., Rockville; Byron Smith, Somers; Ann Giggley, Abbey Rd., South Windsor; Marion Martin, W. Main St., Rockville; Lillian Hanson, Orchard St., Rockville; Joyce Morrison, Sandy Beach Rd., Rockville; Margaret Onthank, Hany Lane, Vernon; Philip Griswold, High Ridge Rd., Rockville; Frances Grosland, Village St., Rockville; Sheila MacKeen, Kelly Rd., Vernon; Shirley Beas, Stafford Springs.

Discharged Thursday: Wilda Cote, Jable Rd., Coventry; Kerry Manley, Union St., Rockville; Josephine Markawicz, RFD 1, Ellington; Marion Teabo, Spring St., Rockville; Pearl Philbrick, Hammond St., Rockville; David Vitner, Hartford Tpk., Vernon; Judith Sauer, Windsor Locks; Lillie Trouton, Orchard St., Rockville; Richard Pinney, W. Main St., Rockville; Stella Colburn, West St., Rockville; Agnes Provost, Ellington Ave., Rockville; Cheryl Gardner, Village St., Rockville; Rebecca Haines, Elm St., Windsor Locks; Mrs. Lynda LaRiviere and son, Hartford Tpk., Rockville; Mrs. Sharon MacVarish and daughter, Snipset Lake Rd., Ellington.

JAN. 22 thru JAN. 28

TV  
Herald



*Ironside . . . 9 p.m. Thursday on NBC*



*Perry Mason . . . 5 p.m. Saturday on Ch. 3*

## Stardom Was Late For Raymond Burr

By LAWRENCE LAURENT  
The Washington Post

WASHINGTON—Stardom came late to Raymond Burr but it came to a man who knew how to enjoy fame and wealth. He was 40 years old when Earl Stanley Gardner chose him to play "Perry Mason." That series lasted for nine seasons on CBS-TV and continues as a top audience program in syndicated re-runs.

Burr worked in nearly every teaching and performing at the scene of about 250 episodes of Pasadena Playhouse and working in some of the worst movies series made him rich, it also left a bad taste. This was a slight, a hurt, an inconsiderate oversight that even a man of Burr's stature finds hard to forget.

When the series began, Burr was issued a wrist watch. It was not particularly expensive but Burr grew fond of it. He kept the watch in repair and paid for having it cleaned. The day the last episode was finished, the property man for the series came into Burr's dressing room and he asked for the watch.

Burr couldn't believe the man wanted the watch. He stood there thinking that his own expenses had already exceeded the cost of the watch. The property man repeated that he needed the watch to close the show's inventory and Burr slowly unstrapped it from his wrist.

He hasn't worn a watch since. No sooner had the Mason series ended than Burr began receiving offers for a new show. He was tired. He sold his beautiful oceanside home north of Malibu and bought himself an island. He paid an estimated 200,000 dollars for Naitauba in the Fiji Islands, complete with 180 residents, a copra plantation, a mine and acres of trees bearing macadamia nuts, passion fruit, mangos, and bread fruit.

What lured Raymond Burr off his island and back into television was the role of Robert T. Ironside. He liked the character of the crusty detective, but equally important was that the role would be played in a wheel chair. Burr had been on his feet for nine years as Perry Mason and the role had taken a heavy toll on his health. Along with those factors was that Burr's own business, Harbour Productions, got a piece of the show.

"Ironside" is now in its fifth season, meaning that the series has reached a level of maximum profit and that Burr will undoubtedly be enriched once more by a long re-run package. The show is being moved in January from 7:30 p.m., Tuesdays to 9 p.m., Thursdays (NBC). Burr was born, 54 years ago, in Westminster, B.C., Canada. He grew up in Vallejo in Northern California and his was not a happy childhood.

He was a fat little boy, going to military school and disliking every minute of it. He was befriended by an elderly woman who had a beautiful garden behind her home. When Burr was not in school, he was in the garden, a tender, sensitive child who found beauty in the flowers. The woman died several years ago and when the property was put up for sale, Raymond Burr bought it.

After graduation Burr went back to Canada and became an actor in repertory theater. Later, he went to England and returned to the United States to teach drama at Columbia University and work in Broadway plays. After World War II service in the U.S. Navy, Burr settled down in southern California,

hoping to land the role of prosecuting attorney Hamilton Burger. Author Gardner saw him and decided that Raymond Burr should become "Perry Mason." The role of Burger went to William Talman, now dead of lung cancer.

To play Mason, Burr went on a dangerous crash diet and lost over 50 pounds. He started the series as a slender 210 but added weight as the years went by. He is, for one thing, a superb gourmet cook and he is, for another, a man who gets tremendous pleasure from eating. He is now, by best estimates, about 275 pounds, but he carries it well on a broad-shouldered 6-foot-1 frame.

He still enjoys talking about dieting, but he's usually too busy with his many projects to concentrate on losing weight. He is interested, for example, in teaching theater in the Watts area of Los Angeles, in a college in Florida, in setting up a University of the Pacific in the Fiji Islands, in looking after hospitalized veterans of Vietnam and in stabilizing the economy of the Fijis. He has also bought a new home, a huge old estate in the Hollywood foothills. It gives him great privacy.

No problems exist on the set of "Ironside," simply because Burr is the boss and everyone knows it. He tried to talk Barbara Anderson into staying in the cast as policewoman Eve Whitfield. She had won an "Emmy" and was certain that a great future beckoned. She left and was replaced by Elizabeth Baur (policewoman Fran Belding).

Don Galloway, who plays Ed Brown, and Don Mitchell, who plays Mark Sanger, continue in the roles they began five seasons ago.

As for Burr, his future is certain and financially secure. "Ironside" will probably be the last TV series for him, and when it ends he will concentrate on his art collection, growing orchids, and making Naitauba the most beautiful island in the Pacific. That is, of course unless someone comes along with another series that Raymond Burr just cannot resist.

SATURDAY

Saturday, January 22
12:00 (1) RFD No. 3 (C)
(2) Johnny Quest (C)
(3) Mr. Wizard (C)
(4) Candelaria Bowling (C)
(5) New Area Theater (C)
(6) "Harris Tubman and Underground Rite" - Dramatic story of Harris Tubman, former slave who repeatedly risked his life to bring freedom to other slaves.
(7) Lancelot Link (C)
(8) The Bugaloos (C)
1:00 (1) CBS Children's Film Festival "Field" Part I - German-made film in Switzerland tells tale of Heidi, young girl raised by her grandfather amid rugged beauty of mountains. Her world is abruptly changed when she is taken by aunt to Frankfurt where she becomes companion to crippled girl, Klara. Part II - Heidi, 30 at 11 p.m.
(2) Death Valley Days (C)
(3) Wrestling (C)
(4) Between You & Me (C)
(5) Roller Derby (C)
(6) College Basketball Long Beach State vs. Loyola (C)
(7) Mr. Ed (C)
2:00 (1) Movie "Man Hunt" '41 British big game hunter devises plan to eliminate Adolf Hitler. Walter Pidgeon, George Sanders, Joan Bennett.
(12-20) College Basketball (C) Fordham vs. Princeton.
(21) McHale's Navy (C)
(22) "The Kanan" - Richard Dix, and the "Kanan" (C)
2:30 (1) Movie "Mary of Scotland" Katherine Hepburn in the role as ill-fated queen who returns to her native land to claim throne that drives her nobles to not wish her to have. Florence, Elizabeth, March & John Garfield.
3:30 (1-40) Pro Bowlers Presentation of \$77,777 Showboat International from Showboat Hotel and Lanes Las Vegas.
4:00 (1) Golf Classic (C)
(2) "Concessions" Berra and Don January meet team of Sam Snead & J. Spind.
(11) Alfred Hitchcock (C)
(12) Thirty Minutes With Ted Koppel (C)
4:30 (1) NBA Highlights (C)
(2) As Schools Match Wisconsin School challenges winner of last week's match.
5:00 (1) Fern Exposure (C)
(2) Karl Addison plans to rob a jewelry store in New York.
(3) Wild World of Sports (C)
(4) Gussie (C)
(5) "The Happening" (C)
(6) Weather - Sports & News (C)
(7) Wild World of Sports (C)
(8) News Boyer (C)
(9) NBC News (C)
(10) NBC News (C)
7:00 (1) National Geographic (C)
(2) "Mandrill: Timoleon and the Field" (C)
(3) Roller Derby (C)
(4) News - Weather (C)
(5) Sports (C)
(6) He-Man (C)
(7) "O'Clock High" (C)
(8) Hogan's Heroes (C)
(9) "The Family" (C)
(10) Lawrence Welk (C)
(11) "World Premiere: Emergency" Robert Fuller, Julie London, Bobby Troup, Kevin Tighe and Randolph Mantooth. Skills of Emergency Hospital's emergency staff and mechanics of Fire Station 51 combine to save lives of five persons. (Premiere)
8:30 (1) "Tyler Moore Show" (C)
(2) "The People" - Kim Darby, Dan O'Herlihy, Survivors of interplanetary disaster find now and better way to live on earth.
9:00 (1) New Dick Van Dyke Show (C)
(2) "The Russians are Coming" - Carl Reiner, Alan Arkin, Eva Marie Saint, Brian Keith, and Jonathan Winters. Theodore Sikel and Paul Ford. Small town on island off New England coast gets up in arms when Russian sub runs aground and crew asks for assistance.
(11) Johnny Mann Stand Up and Cheer (C)
(12) "Arnie" (C)
(13) "Illustrated" (C)
10:00 (1) Mission: Impossible (C)
(2) "Sixth Sense" (C)
(3) "Guest: Walter Matthau" (C)
10:30 (1) Oral Roberts (C)
11:00 (1) News - Weather (C)
11:30 (1) "Rio Bravo" '59 Sheriff holds killer in town jail for five days until Federal marshal arrives and finds task more difficult than he anticipated. John Wayne, Dean Jagger.
(2) "The Monocle" '61. Elsa Martinell, Robert Hossain.
11:50 (1) News - Weather (C)
(2) "The Saint" (C)
(3) "Sunset Strip" (C)
12:00 (1) Movie "The Accused" '68 Lorretta Young, Robert Cummings and Wendell Corey. School teacher accidentally kills amorous student and tries to get away with it.
(2) Movie "The Bank Job" Boris Karloff and Deia Logan & David Manners.
1:30 (1) News & Sign Off (C)

SUNDAY

Sunday, January 23
7:00 (1) This is the Life (C)
(2) Worship for Shut-ins (C)
(3) Ring Around the World (C)
7:30 (1) Sign On and Prayer (C)
(2) Davey & Goliath (C)
8:00 (1) Davey and Goliath (C)
(2) Church Service - Catholic (C)
(3) Tennessee Tuxedo and His Friends (C)
8:15 (1) Adventures of Gumbby (C)
(2) Sacred Heart (C)
8:30 (1) This is the Life (C)
(2) Thunderbirds (C)
9:00 (1) Leer Sim Leiras: Reading Without Letters (C)
(2) Faith for Today (C)
(3) Understanding (C)
9:15 (1) Que Pasa De Nuevos? What's New (C)
(2) We Believe (C)
(3) Dialogue (C)
(4) Capt. Scarlet (C)
(5) Kamen (C)
(6) Christophers (C)
10:00 (1) Lamp Into My Foot (C)
(2) A New Day (C)
(3) Chance of Salvation (C)
(4) Let Us Celebrate (C)
10:30 (1) Look Up and Live (C)
(2) Doublecheckers (C)
(3) Church Service - Catholic (C)
(4) Sports Challenge Football Giants vs. Chicago Blackbears (C)
11:00 (1) Camera Three (C)
(2) Camera Three (C)
(3) Sports Challenge Football Giants vs. Chicago Blackbears (C)
11:15 (1) Jewish Life (C)
11:30 (1) College Campus (C)
(2) Joseph Collins (C)
(3) Make a Wish (C)
(4) NFL Action (C)
(5) NFL Action (C)
12:00 (1) Speaking for the Consumer Mother M. Bernadette de Lourdes, Commissioner of the Conn. State Dept. of Consumer Affairs.
(2) "The Elderly" (C)
(3) College Basketball Villanova Wildcats vs. St. John's Redmen.
(4) "The Day the Leaves Clipped Hands" (C)
(5) Original drama by Allan Stone, telling story of old farmer who fights losing battle against advancing tide of "development" in affluent society that has no place for him.
12:15 (1) Health Beat (C)
12:30 (1) Face the Nation (C)
(2) Black is (C)
(3) No Miracle But Love (C)
Special exploring world of the retarded child. Program was filmed at Bethesda Lutheran Home in Watertown, Wisconsin.
1:00 (1) Teen Community (C)
(2) Meet the Press (C)
(3) Eighth Day (C)
(4) Conversations With (C)
Dr. John Zadorovny, obstetrician, Dr. A. Blake, podiatrist, Mrs. S. Kaufman, coordinator, March of Dimes Campaign. Subject: Birth defects; diagnosis, treatment & treatment finding.
1:30 (1) American Adventure (C)
(2) Exciting contemporary adventure in unspoiled wilderness on windswept peak and in some of world's most unusual spots.
(3) Laurel and Hardy (C)
2:00 (1) Sign On and Prayer (C)
2:30 (1) News (C)
(2) Davey & Goliath (C)
2:45 (1) Eighth Day (C)
3:00 (1) Year Community (C)
(2) Consultation (C)
3:15 (1) Health Beat (C)
3:30 (1) Weather & Special Report (C)
3:45 (1) News (C)
3:55 (1) News (C)
4:00 (1) Mr. Goober (C)
4:15 (1) Heritage Corner (C)
4:30 (1) Captain Kangaroo (C)
(2) Strum 'N' Drummer (C)
4:45 (1) "The Family" (C)
4:55 (1) "The Family" (C)
5:00 (1) "The Family" (C)
5:15 (1) "The Family" (C)
5:30 (1) "The Family" (C)
5:45 (1) "The Family" (C)
6:00 (1) "The Family" (C)
6:15 (1) "The Family" (C)
6:30 (1) "The Family" (C)
6:45 (1) "The Family" (C)
7:00 (1) "The Family" (C)
7:15 (1) "The Family" (C)
7:30 (1) "The Family" (C)
7:45 (1) "The Family" (C)
8:00 (1) "The Family" (C)
8:15 (1) "The Family" (C)
8:30 (1) "The Family" (C)
8:45 (1) "The Family" (C)
9:00 (1) "The Family" (C)
9:15 (1) "The Family" (C)
9:30 (1) "The Family" (C)
9:45 (1) "The Family" (C)
10:00 (1) "The Family" (C)
10:15 (1) "The Family" (C)
10:30 (1) "The Family" (C)
10:45 (1) "The Family" (C)
11:00 (1) "The Family" (C)
11:15 (1) "The Family" (C)
11:30 (1) "The Family" (C)
11:45 (1) "The Family" (C)
12:00 (1) "The Family" (C)

MONDAY

Monday, January 24
1:00 (1) Virginia Graham Show (C)
(2) "What's My Line?" (C)
(3) "As Home With Kitty" (C)
(4) "Tales of Wells Fargo" (C)
(5) "All My Children" (C)
1:30 (1) As the World Turns (C)
(2) "Three On a Match" (C)
(3-4) Let's Make a Deal (C)
2:00 (1) Love is a Many Splendored Thing (C)
(2-3) Days of Our Lives (C)
(4-5) Newlywed Game (C)
2:30 (1) Guiding Light (C)
(2-3) The Doctors (C)
(4-5) Dating Game (C)
3:00 (1) My Three Sons (C)
(2-3) "Another World" (C)
(4-5) General Hospital (C)
3:30 (1) Bachelor Station (C)
(2-3) Bright Evening (C)
(4-5) One Life to Live (C)
(6) Gomer Pyle (C)
4:00 (1) Family Affair (C)
(2-3) "American Style" (C)
(4-5) Love & Willy (C)
4:30 (1) Andy Griffith Show (C)
(2) Mike Douglas Show (C)
(3) Mary Griffin (C)
(4-5) "Kluge's" (C)
4:45 (1) Weather Watch (C)
5:00 (1) Big Valley (C)
(2) I Dream of Jeannie (C)
(3) Timmy and Luanne (C)
(4) Dragnet (C)
(5) "Hogan's Heroes" (C)
(6) "G.I. Joe" (C)
(7) "News, Weather & Sports" (C)
(8) "What's Happening" (C)
(9) "The Dick Van Dyke Show" (C)
(10) "The Mary Tyler Moore Show" (C)
(11) "The Dick Van Dyke Show" (C)
(12) "The Mary Tyler Moore Show" (C)
5:30 (1) "The Dick Van Dyke Show" (C)
(2) "The Mary Tyler Moore Show" (C)
(3) "The Dick Van Dyke Show" (C)
(4) "The Mary Tyler Moore Show" (C)
(5) "The Dick Van Dyke Show" (C)
(6) "The Mary Tyler Moore Show" (C)
(7) "The Dick Van Dyke Show" (C)
(8) "The Mary Tyler Moore Show" (C)
(9) "The Dick Van Dyke Show" (C)
(10) "The Mary Tyler Moore Show" (C)
(11) "The Dick Van Dyke Show" (C)
(12) "The Mary Tyler Moore Show" (C)
6:00 (1) "The Dick Van Dyke Show" (C)
(2) "The Mary Tyler Moore Show" (C)
(3) "The Dick Van Dyke Show" (C)
(4) "The Mary Tyler Moore Show" (C)
(5) "The Dick Van Dyke Show" (C)
(6) "The Mary Tyler Moore Show" (C)
(7) "The Dick Van Dyke Show" (C)
(8) "The Mary Tyler Moore Show" (C)
(9) "The Dick Van Dyke Show" (C)
(10) "The Mary Tyler Moore Show" (C)
(11) "The Dick Van Dyke Show" (C)
(12) "The Mary Tyler Moore Show" (C)
6:30 (1) "The Dick Van Dyke Show" (C)
(2) "The Mary Tyler Moore Show" (C)
(3) "The Dick Van Dyke Show" (C)
(4) "The Mary Tyler Moore Show" (C)
(5) "The Dick Van Dyke Show" (C)
(6) "The Mary Tyler Moore Show" (C)
(7) "The Dick Van Dyke Show" (C)
(8) "The Mary Tyler Moore Show" (C)
(9) "The Dick Van Dyke Show" (C)
(10) "The Mary Tyler Moore Show" (C)
(11) "The Dick Van Dyke Show" (C)
(12) "The Mary Tyler Moore Show" (C)
7:00 (1) "The Dick Van Dyke Show" (C)
(2) "The Mary Tyler Moore Show" (C)
(3) "The Dick Van Dyke Show" (C)
(4) "The Mary Tyler Moore Show" (C)
(5) "The Dick Van Dyke Show" (C)
(6) "The Mary Tyler Moore Show" (C)
(7) "The Dick Van Dyke Show" (C)
(8) "The Mary Tyler Moore Show" (C)
(9) "The Dick Van Dyke Show" (C)
(10) "The Mary Tyler Moore Show" (C)
(11) "The Dick Van Dyke Show" (C)
(12) "The Mary Tyler Moore Show" (C)
7:30 (1) "The Dick Van Dyke Show" (C)
(2) "The Mary Tyler Moore Show" (C)
(3) "The Dick Van Dyke Show" (C)
(4) "The Mary Tyler Moore Show" (C)
(5) "The Dick Van Dyke Show" (C)
(6) "The Mary Tyler Moore Show" (C)
(7) "The Dick Van Dyke Show" (C)
(8) "The Mary Tyler Moore Show" (C)
(9) "The Dick Van Dyke Show" (C)
(10) "The Mary Tyler Moore Show" (C)
(11) "The Dick Van Dyke Show" (C)
(12) "The Mary Tyler Moore Show" (C)
8:00 (1) "The Dick Van Dyke Show" (C)
(2) "The Mary Tyler Moore Show" (C)
(3) "The Dick Van Dyke Show" (C)
(4) "The Mary Tyler Moore Show" (C)
(5) "The Dick Van Dyke Show" (C)
(6) "The Mary Tyler Moore Show" (C)
(7) "The Dick Van Dyke Show" (C)
(8) "The Mary Tyler Moore Show" (C)
(9) "The Dick Van Dyke Show" (C)
(10) "The Mary Tyler Moore Show" (C)
(11) "The Dick Van Dyke Show" (C)
(12) "The Mary Tyler Moore Show" (C)
8:30 (1) "The Dick Van Dyke Show" (C)
(2) "The Mary Tyler Moore Show" (C)
(3) "The Dick Van Dyke Show" (C)
(4) "The Mary Tyler Moore Show" (C)
(5) "The Dick Van Dyke Show" (C)
(6) "The Mary Tyler Moore Show" (C)
(7) "The Dick Van Dyke Show" (C)
(8) "The Mary Tyler Moore Show" (C)
(9) "The Dick Van Dyke Show" (C)
(10) "The Mary Tyler Moore Show" (C)
(11) "The Dick Van Dyke Show" (C)
(12) "The Mary Tyler Moore Show" (C)
9:00 (1) "The Dick Van Dyke Show" (C)
(2) "The Mary Tyler Moore Show" (C)
(3) "The Dick Van Dyke Show" (C)
(4) "The Mary Tyler Moore Show" (C)
(5) "The Dick Van Dyke Show" (C)
(6) "The Mary Tyler Moore Show" (C)
(7) "The Dick Van Dyke Show" (C)
(8) "The Mary Tyler Moore Show" (C)
(9) "The Dick Van Dyke Show" (C)
(10) "The Mary Tyler Moore Show" (C)
(11) "The Dick Van Dyke Show" (C)
(12) "The Mary Tyler Moore Show" (C)
9:30 (1) "The Dick Van Dyke Show" (C)
(2) "The Mary Tyler Moore Show" (C)
(3) "The Dick Van Dyke Show" (C)
(4) "The Mary Tyler Moore Show" (C)
(5) "The Dick Van Dyke Show" (C)
(6) "The Mary Tyler Moore Show" (C)
(7) "The Dick Van Dyke Show" (C)
(8) "The Mary Tyler Moore Show" (C)
(9) "The Dick Van Dyke Show" (C)
(10) "The Mary Tyler Moore Show" (C)
(11) "The Dick Van Dyke Show" (C)
(12) "The Mary Tyler Moore Show" (C)
10:00 (1) "The Dick Van Dyke Show" (C)
(2) "The Mary Tyler Moore Show" (C)
(3) "The Dick Van Dyke Show" (C)
(4) "The Mary Tyler Moore Show" (C)
(5) "The Dick Van Dyke Show" (C)
(6) "The Mary Tyler Moore Show" (C)
(7) "The Dick Van Dyke Show" (C)
(8) "The Mary Tyler Moore Show" (C)
(9) "The Dick Van Dyke Show" (C)
(10) "The Mary Tyler Moore Show" (C)
(11) "The Dick Van Dyke Show" (C)
(12) "The Mary Tyler Moore Show" (C)
10:30 (1) "The Dick Van Dyke Show" (C)
(2) "The Mary Tyler Moore Show" (C)
(3) "The Dick Van Dyke Show" (C)
(4) "The Mary Tyler Moore Show" (C)
(5) "The Dick Van Dyke Show" (C)
(6) "The Mary Tyler Moore Show" (C)
(7) "The Dick Van Dyke Show" (C)
(8) "The Mary Tyler Moore Show" (C)
(9) "The Dick Van Dyke Show" (C)
(10) "The Mary Tyler Moore Show" (C)
(11) "The Dick Van Dyke Show" (C)
(12) "The Mary Tyler Moore Show" (C)
11:00 (1) "The Dick Van Dyke Show" (C)
(2) "The Mary Tyler Moore Show" (C)
(3) "The Dick Van Dyke Show" (C)
(4) "The Mary Tyler Moore Show" (C)
(5) "The Dick Van Dyke Show" (C)
(6) "The Mary Tyler Moore Show" (C)
(7) "The Dick Van Dyke Show" (C)
(8) "The Mary Tyler Moore Show" (C)
(9) "The Dick Van Dyke Show" (C)
(10) "The Mary Tyler Moore Show" (C)
(11) "The Dick Van Dyke Show" (C)
(12) "The Mary Tyler Moore Show" (C)
11:30 (1) "The Dick Van Dyke Show" (C)
(2) "The Mary Tyler Moore Show" (C)
(3) "The Dick Van Dyke Show" (C)
(4) "The Mary Tyler Moore Show" (C)
(5) "The Dick Van Dyke Show" (C)
(6) "The Mary Tyler Moore Show" (C)
(7) "The Dick Van Dyke Show" (C)
(8) "The Mary Tyler Moore Show" (C)
(9) "The Dick Van Dyke Show" (C)
(10) "The Mary Tyler Moore Show" (C)
(11) "The Dick Van Dyke Show" (C)
(12) "The Mary Tyler Moore Show" (C)
12:00 (1) "The Dick Van Dyke Show" (C)
(2) "The Mary Tyler Moore Show" (C)
(3) "The Dick Van Dyke Show" (C)
(4) "The Mary Tyler Moore Show" (C)
(5) "The Dick Van Dyke Show" (C)
(6) "The Mary Tyler Moore Show" (C)
(7) "The Dick Van Dyke Show" (C)
(8) "The Mary Tyler Moore Show" (C)
(9) "The Dick Van Dyke Show" (C)
(10) "The Mary Tyler Moore Show" (C)
(11) "The Dick Van Dyke Show" (C)
(12) "The Mary Tyler Moore Show" (C)

TUESDAY

Tuesday, January 25
1:00 (1) Virginia Graham Show (C)
(2) "What's My Line?" (C)
(3) "As Home With Kitty" (C)
(4) "Tales of Wells Fargo" (C)
(5) "All My Children" (C)
1:30 (1) As the World Turns (C)
(2) "Three On a Match" (C)
(3-4) Let's Make a Deal (C)
2:00 (1) Love is a Many Splendored Thing (C)
(2-3) Days of Our Lives (C)
(4-5) Newlywed Game (C)
2:30 (1) Guiding Light (C)
(2-3) The Doctors (C)
(4-5) Dating Game (C)
3:00 (1) My Three Sons (C)
(2-3) "Another World" (C)
(4-5) General Hospital (C)
3:30 (1) Bachelor Station (C)
(2-3) Bright Evening (C)
(4-5) One Life to Live (C)
(6) Gomer Pyle (C)
4:00 (1) Family Affair (C)
(2-3) "American Style" (C)
(4-5) Love & Willy (C)
4:30 (1) Andy Griffith Show (C)
(2) Mike Douglas Show (C)
(3) Mary Griffin (C)
(4-5) "Kluge's" (C)
4:45 (1) Weather Watch (C)
5:00 (1) Big Valley (C)
(2) I Dream of Jeannie (C)
(3) Timmy and Luanne (C)
(4) Dragnet (C)
(5) "Hogan's Heroes" (C)
(6) "G.I. Joe" (C)
(7) "News, Weather & Sports" (C)
(8) "What's Happening" (C)
(9) "The Dick Van Dyke Show" (C)
(10) "The Mary Tyler Moore Show" (C)
(11) "The Dick Van Dyke Show" (C)
(12) "The Mary Tyler Moore Show" (C)
5:30 (1) "The Dick Van Dyke Show" (C)
(2) "The Mary Tyler Moore Show" (C)
(3) "The Dick Van Dyke Show" (C)
(4) "The Mary Tyler Moore Show" (C)
(5) "The Dick Van Dyke Show" (C)
(6) "The Mary Tyler Moore Show" (C)
(7) "The Dick Van Dyke Show" (C)
(8) "The Mary Tyler Moore Show" (C)
(9) "The Dick Van Dyke Show" (C)
(10) "The Mary Tyler Moore Show" (C)
(11) "The Dick Van Dyke Show" (C)
(12) "The Mary Tyler Moore Show" (C)
6:00 (1) "The Dick Van Dyke Show" (C)
(2) "The Mary Tyler Moore Show" (C)
(3) "The Dick Van Dyke Show" (C)
(4) "The Mary Tyler Moore Show" (C)
(5) "The Dick Van Dyke Show" (C)
(6) "The Mary Tyler Moore Show" (C)
(7) "The Dick Van Dyke Show" (C)
(8) "The Mary Tyler Moore Show" (C)
(9) "The Dick Van Dyke Show" (C)
(10) "The Mary Tyler Moore Show" (C)
(11) "The Dick Van Dyke Show" (C)
(12) "The Mary Tyler Moore Show" (C)
6:30 (1) "The Dick Van Dyke Show" (C)
(2) "The Mary Tyler Moore Show" (C)
(3) "The Dick Van Dyke Show" (C)
(4) "The Mary Tyler Moore Show" (C)
(5) "The Dick Van Dyke Show" (C)
(6) "The Mary Tyler Moore Show" (C)
(7) "The Dick Van Dyke Show" (C)
(8) "The Mary Tyler Moore Show" (C)
(9) "The Dick Van Dyke Show" (C)
(10) "The Mary Tyler Moore Show" (C)
(11) "The Dick Van Dyke Show" (C)
(12) "The Mary Tyler Moore Show" (C)
7:00 (1) "The Dick Van Dyke Show" (C)
(2) "The Mary Tyler Moore Show" (C)
(3) "The Dick Van Dyke Show" (C)
(4) "The Mary Tyler Moore Show" (C)
(5) "The Dick Van Dyke Show" (C)
(6) "The Mary Tyler Moore Show" (C)
(7) "The Dick Van Dyke Show" (C)
(8) "The Mary Tyler Moore Show" (C)
(9) "The Dick Van Dyke Show" (C)
(10) "The Mary Tyler Moore Show" (C)
(11) "The Dick Van Dyke Show" (C)
(12) "The Mary Tyler Moore Show" (C)
7:30 (1) "The Dick Van Dyke Show" (C)
(2) "The Mary Tyler Moore Show" (C)
(3) "The Dick Van Dyke Show" (C)
(4) "The Mary Tyler Moore Show" (C)
(5) "The Dick Van Dyke Show" (C)
(6) "The Mary Tyler Moore Show" (C)
(7) "The Dick Van Dyke Show" (C)
(8) "The Mary Tyler Moore Show" (C)
(9) "The Dick Van Dyke Show" (C)
(10) "The Mary Tyler Moore Show" (C)
(11) "The Dick Van Dyke Show" (C)
(12) "The Mary Tyler Moore Show" (C)
8:00 (1) "The Dick Van Dyke Show" (C)
(2) "The Mary Tyler Moore Show" (C)
(3) "The Dick Van Dyke Show" (C)
(4) "The Mary Tyler Moore Show" (C)
(5) "The Dick Van Dyke Show" (C)
(6) "The Mary Tyler Moore Show" (C)
(7) "The Dick Van Dyke Show" (C)
(8) "The Mary Tyler Moore Show" (C)
(9) "The Dick Van Dyke Show" (C)
(10) "The Mary Tyler Moore Show" (C)
(11) "The Dick Van Dyke Show" (C)
(12) "The Mary Tyler Moore Show" (C)
8:30 (1) "The Dick Van Dyke Show" (C)
(2) "The Mary Tyler Moore Show" (C)
(3) "The Dick Van Dyke Show" (C)
(4) "The Mary Tyler Moore Show" (C)
(5) "The Dick Van Dyke Show" (C)
(6) "The Mary Tyler Moore Show" (C)
(7) "The Dick Van Dyke Show" (C)
(8) "The Mary Tyler Moore Show" (C)
(9) "The Dick Van Dyke Show" (C)
(10) "The Mary Tyler Moore Show" (C)
(11) "The Dick Van Dyke Show" (C)
(12) "The Mary Tyler Moore Show" (C)
9:00 (1) "The Dick Van Dyke Show" (C)
(2) "The Mary Tyler Moore Show" (C)
(3) "The Dick Van Dyke Show" (C)
(4) "The Mary Tyler Moore Show" (C)
(5) "The Dick Van Dyke Show" (C)
(6) "The Mary Tyler Moore Show" (C)
(7) "The Dick Van Dyke Show" (C)
(8) "The Mary Tyler Moore Show" (C)
(9) "The Dick Van Dyke Show" (C)
(10) "The Mary Tyler Moore Show" (C)
(11) "The Dick Van Dyke Show" (C)
(12) "The Mary Tyler Moore Show" (C)
9:30 (1) "The Dick Van Dyke Show" (C)
(2) "The Mary Tyler Moore Show" (C)
(3) "The Dick Van Dyke Show" (C)
(4) "The Mary Tyler Moore Show" (C)
(5) "The Dick Van Dyke Show" (C)
(6) "The Mary Tyler Moore Show" (C)
(7) "The Dick Van Dyke Show" (C)
(8) "The Mary Tyler Moore Show" (C)
(9) "The Dick Van Dyke Show" (C)
(10) "The Mary Tyler Moore Show" (C)
(11) "The Dick Van Dyke Show" (C)
(12) "The Mary Tyler Moore Show" (C)
10:00 (1) "The Dick Van Dyke Show" (C)
(2) "The Mary Tyler Moore Show" (C)
(3) "The Dick Van Dyke Show" (C)
(4) "The Mary Tyler Moore Show" (C)
(5) "The Dick Van Dyke Show" (C)
(6) "The Mary Tyler Moore Show" (C)
(7) "The Dick Van Dyke Show" (C)
(8) "The Mary Tyler Moore Show" (C)
(9) "The Dick Van Dyke Show" (C)
(10) "The Mary Tyler Moore Show" (C)
(11) "The Dick Van Dyke Show" (C)
(12) "The Mary Tyler Moore Show" (C)
10:30 (1) "The Dick Van Dyke Show" (C)
(2) "The Mary Tyler Moore Show" (C)
(3) "The Dick Van Dyke Show" (C)
(4) "The Mary Tyler Moore Show" (C)
(5) "The Dick Van Dyke Show" (C)
(6) "The Mary Tyler Moore Show" (C)
(7) "The Dick Van Dyke Show" (C)
(8) "The Mary Tyler Moore Show" (C)
(9) "The Dick Van Dyke Show" (C)
(10) "The Mary Tyler Moore Show" (C)
(11) "The Dick Van Dyke Show" (C)
(12) "The Mary Tyler Moore Show" (C)
11:00 (1) "The Dick Van Dyke Show" (C)
(2) "The Mary Tyler Moore Show" (C)
(3) "The Dick Van Dyke Show" (C)
(4) "The Mary Tyler Moore Show" (C)
(5) "The Dick Van Dyke Show" (C)
(6) "The Mary Tyler Moore Show" (C)
(7) "The Dick Van Dyke Show" (C)
(8) "The Mary Tyler Moore Show" (C)
(9) "The Dick Van Dyke Show" (C)
(10) "The Mary Tyler Moore Show" (C)
(11) "The Dick Van Dyke Show" (C)
(12) "The Mary Tyler Moore Show" (C)
11:30 (1) "The Dick Van Dyke Show" (C)
(2) "The Mary Tyler Moore Show" (C)
(3) "The Dick Van Dyke Show" (C)
(4) "The Mary Tyler Moore Show" (C)
(5) "The Dick Van Dyke Show" (C)
(6) "The Mary Tyler Moore Show" (C)
(7) "The Dick Van Dyke Show" (C)
(8) "The Mary Tyler Moore Show" (C)
(9) "The Dick Van Dyke Show" (C)
(10) "The Mary Tyler Moore Show" (C)
(11) "The Dick Van Dyke Show" (C)
(12) "The Mary Tyler Moore Show" (C)
12:00 (1) "The Dick Van Dyke Show" (C)
(2) "The Mary Tyler Moore Show" (C)
(3) "The Dick Van Dyke Show" (C)
(4) "The Mary Tyler Moore Show" (C)
(5) "The Dick Van Dyke Show" (C)
(6) "The Mary Tyler Moore Show" (C)
(7) "The Dick Van Dyke Show" (C)
(8) "The Mary Tyler Moore Show" (C)
(9) "The Dick Van Dyke Show" (C)
(10) "The Mary Tyler Moore Show" (C)
(11) "The Dick Van Dyke Show" (C)
(12) "The Mary Tyler Moore Show" (C)

WEDNESDAY

Wednesday, January 26
1:00 (1) Virginia Graham Show (C)
(2) "What's My Line?" (C)
(3) "As Home With Kitty" (C)
(4) "Tales of Wells Fargo" (C)
(5) "All My Children" (C)
1:30 (1) As the World Turns (C)
(2) "Three On a Match" (C)
(3-4) Let's Make a Deal (C)
2:00 (1) Love is a Many Splendored Thing (C)
(2-3) Days of Our Lives (C)
(4-5) Newlywed Game (C)
2:30 (1) Guiding Light (C)
(2-3) The Doctors (C)
(4-5) Dating Game (C)
3:00 (1) My Three Sons (C)
(2-3) "Another World" (C)
(4-5) General Hospital (C)
3:30 (1) Bachelor Station (C)
(2-3) Bright Evening (C)
(4-5) One Life to Live (C)
(6) Gomer Pyle (C)
4:00 (1) Family Affair (C)
(2-3) "American Style" (C)
(4-5) Love & Willy (C)
4:30 (1) Andy Griffith Show (C)
(2) Mike Douglas Show (C)
(3) Mary Griffin (C)
(4-5) "Kluge's" (C)
4:45 (1) Weather Watch (C)
5:00 (1) Big Valley (C)
(2) I Dream of Jeannie (C)
(3) Timmy and Luanne (C)
(4) Dragnet (C)
(5) "Hogan's Heroes" (C)
(6) "G.I. Joe" (C)
(7) "News, Weather & Sports" (C)
(8) "What's Happening" (C)
(9) "The Dick Van Dyke Show" (C)
(10) "The Mary Tyler Moore Show" (C)
(11) "The Dick Van Dyke Show" (C)
(12) "The Mary Tyler Moore Show" (C)
5:30 (1) "The Dick Van Dyke Show" (C)
(2) "The Mary Tyler Moore Show" (C)
(3) "The Dick Van Dyke Show" (C)
(4) "The Mary Tyler Moore Show" (C)
(5) "The Dick Van Dyke Show" (C)
(6) "The Mary Tyler Moore Show" (C)
(7) "The Dick Van Dyke Show" (C)
(8) "The Mary Tyler Moore Show" (C)
(9) "The Dick Van Dyke Show" (C)
(10) "The Mary Tyler Moore Show" (C)
(11) "The Dick Van Dyke Show" (C)
(12) "The Mary Tyler Moore Show" (C)
6:00 (1) "The Dick Van Dyke Show" (C)
(2) "The Mary Tyler Moore Show" (C)
(3) "The Dick Van Dyke Show" (C)
(4) "The Mary Tyler Moore Show" (C)
(5) "The Dick Van Dyke Show" (C)
(6) "The Mary Tyler Moore Show" (C)
(7) "The Dick Van Dyke Show" (C)
(8) "The Mary Tyler Moore Show" (C)
(9) "The Dick Van Dyke Show" (C)
(10) "The Mary Tyler Moore Show" (C)
(11) "The Dick Van Dyke Show" (C)
(12) "The Mary Tyler Moore Show" (C)
6:30 (1) "The Dick Van Dyke Show" (C)
(2) "The Mary Tyler Moore Show" (C)
(3) "The Dick Van Dyke Show" (C)
(4) "The Mary Tyler Moore Show" (C)
(5) "The Dick Van Dyke Show" (C)
(6) "The Mary Tyler Moore Show" (C)
(7) "The Dick Van Dyke Show" (C)
(8) "The Mary Tyler Moore Show" (C)
(9) "The Dick Van Dyke Show" (C)
(10) "The Mary Tyler Moore Show" (C)
(11) "The Dick Van Dyke Show" (C)
(12) "The Mary Tyler Moore Show" (C)
7:00 (1) "The Dick Van Dyke Show" (C)
(2) "The Mary Tyler Moore Show" (C)
(3) "The Dick Van Dyke Show" (C)
(4) "The Mary Tyler Moore Show" (C)
(5) "The Dick Van Dyke Show" (C)
(6) "The Mary Tyler Moore Show" (C)
(7) "The Dick Van Dyke Show" (C)
(8) "The Mary Tyler Moore Show" (C)
(9) "The Dick Van Dyke Show" (C)
(10) "The Mary Tyler Moore Show" (C)
(11) "The Dick Van Dyke Show" (C)
(12) "The Mary Tyler Moore Show" (C)
7:30 (1) "The Dick Van Dyke Show" (C)
(2) "The Mary Tyler Moore Show" (C)
(3) "The Dick Van Dyke Show" (C)
(4) "The Mary Tyler Moore Show" (C)
(5) "The Dick Van Dyke Show" (C)
(6) "The Mary Tyler Moore Show" (C)
(7) "The Dick Van Dyke Show" (C)
(8) "The Mary Tyler Moore Show" (C)
(9) "The Dick Van Dyke Show" (C)
(10) "The Mary Tyler Moore Show" (C)
(11) "The Dick Van Dyke Show" (C)
(12) "The Mary Tyler Moore Show" (C)
8:00 (1) "The Dick Van Dyke Show" (C)
(2) "The Mary Tyler Moore Show" (C)
(3) "The Dick Van Dyke Show" (C)
(4) "The Mary Tyler Moore Show" (C)
(5) "The Dick Van Dyke Show" (C)
(6) "The Mary Tyler Moore Show" (C)
(7) "The Dick Van Dyke Show" (C)
(8) "The Mary Tyler Moore Show" (C)
(9) "The Dick Van Dyke Show" (C)
(10) "The Mary Tyler Moore Show" (C)
(11) "The Dick Van Dyke Show" (C)
(12) "The Mary Tyler Moore Show" (C)
8:30 (1) "The Dick Van Dyke Show" (C)
(2) "The Mary Tyler Moore Show" (C)
(3) "The Dick Van Dyke Show" (C)
(4) "The Mary Tyler Moore Show" (C)
(5) "The Dick Van Dyke Show" (C)
(6) "The Mary Tyler Moore Show" (C)
(7) "The Dick Van Dyke Show" (C)
(8) "The Mary Tyler Moore Show" (C)
(9) "The Dick Van Dyke Show" (C)
(10) "The Mary Tyler Moore Show" (C)
(11) "The Dick Van Dyke Show" (C)
(12) "The Mary Tyler Moore Show" (C)
9:00 (1) "The Dick Van Dyke Show" (C)
(2) "The Mary Tyler Moore Show" (C)
(3) "The Dick Van Dyke Show" (C)
(4) "The Mary Tyler Moore Show" (C)
(5) "The Dick Van Dyke Show" (C)
(6) "The Mary Tyler Moore Show" (C)
(7) "The Dick Van Dyke Show" (C)
(8) "The Mary Tyler Moore Show" (C)
(9) "The Dick Van Dyke Show" (C)
(10) "The Mary Tyler Moore Show" (C)
(11) "The Dick Van Dyke Show" (C)
(12) "The Mary Tyler Moore Show" (C)
9:30 (1) "The Dick Van Dyke Show" (C)
(2) "The Mary Tyler Moore Show" (C)
(3) "The Dick Van Dyke Show" (C)
(4) "The Mary Tyler Moore Show" (C)
(5) "The Dick Van Dyke Show" (C)
(6) "The Mary Tyler Moore Show" (C)
(7) "The Dick Van Dyke Show" (C)
(8) "The Mary Tyler Moore Show" (C)
(9) "The Dick Van Dyke Show" (C)
(10) "The Mary Tyler Moore Show" (C)
(11) "The Dick Van Dyke Show" (C)
(12) "The Mary Tyler Moore Show" (C)
10:00 (1) "The Dick Van Dyke Show" (C)
(2) "The Mary Tyler Moore Show" (C)
(3) "The Dick Van Dyke Show" (C)
(4) "The Mary Tyler Moore Show" (C)
(5) "The Dick Van Dyke Show" (C)
(6) "The Mary Tyler Moore Show" (C)
(7) "The Dick Van Dyke Show" (C)
(8) "The Mary Tyler Moore Show" (C)
(9) "The Dick Van Dyke Show" (C)
(10) "The Mary Tyler Moore Show" (C)
(11) "The Dick Van Dyke Show" (C)
(12) "The Mary Tyler Moore Show" (C)
10:30 (1) "The Dick Van Dyke Show" (C)
(2) "The Mary Tyler Moore Show" (C)
(3) "The Dick Van Dyke Show" (C)
(4) "The Mary Tyler Moore Show" (C)
(5) "The Dick Van Dyke Show" (C)
(6) "The Mary Tyler Moore Show" (C)
(7) "The Dick Van Dyke Show" (C)
(8) "The Mary Tyler Moore Show" (C)
(9) "The Dick Van Dyke Show" (C)
(10) "The Mary Tyler Moore Show" (C)
(11) "The Dick Van Dyke Show" (C)
(12) "The Mary Tyler Moore Show" (C)
11:00 (1) "The Dick Van Dyke Show" (C)
(2) "The Mary Tyler Moore Show" (C)
(3) "The Dick Van Dyke Show" (C)
(4) "The Mary Tyler Moore Show" (C)
(5) "The Dick Van Dyke Show" (C)
(6) "The Mary Tyler Moore Show" (C)
(7) "The Dick Van Dyke Show" (C)
(8) "The Mary Tyler Moore Show" (C)
(9) "The Dick Van Dyke Show" (C)
(10) "The Mary Tyler Moore Show" (C)
(11) "The Dick Van Dyke Show" (C)
(12) "The Mary Tyler Moore Show" (C)
11:30 (1) "The Dick Van Dyke Show" (C)
(2) "The Mary Tyler Moore Show" (C)
(3) "The Dick Van Dyke Show" (C)
(4) "The Mary Tyler Moore Show" (C)
(5) "The Dick Van Dyke Show" (C)
(6) "The Mary Tyler Moore Show" (C)
(7) "The Dick Van Dyke Show" (C)
(8) "The Mary Tyler Moore Show" (C)
(9) "The Dick Van Dyke Show" (C)
(10) "The Mary Tyler Moore Show" (C)
(11) "The Dick Van Dyke Show" (C)
(12) "The Mary Tyler Moore Show" (C)
12:00 (1

THURSDAY

- Thursday, January 27
- 1:00 (3) Virginia Graham Show (C)
  - (8) What's My Line? (C)
  - (23) At Home With Kitty (C)
  - Amateur chef J. Tomassetti prepares stuffed beef rollatini; Y. Hood with "Let's Put It All Together"; and "Fashions in Sewing."
  - (30) Tales of Wells Fargo (C)
  - (40) All My Children (C)
  - 1:30 (3) As the World Turns (C)
  - (30) Three On a Match (C)
  - (8-40) Let's Make a Deal (C)
  - 2:00 (8) Love Is a Many Splendored Thing (C)
  - (23-30) Days of Our Lives (C)
  - (8-40) Newlywed Game (C)
  - 2:30 (3) Guiding Light (C)
  - (23-30) The Doctors (C)
  - (8-40) Dating Game (C)
  - 3:00 (3) My Three Sons (C)
  - (23-30) Another World (C)
  - (8-40) General Hospital (C)
  - 3:30 (3) Ranger Station (C)
  - (23-30) Bright Promise (C)
  - (8-40) One Life to Live (C)
  - (18) Gomer Pyle (C)
  - 4:00 (3) Family Affair (C)
  - (23-30) Somerset (C)
  - (8-40) Love American Style (C)
  - (18) Pete and Willy (C)
  - 4:30 (3) Andy Griffith Show (C)
  - (8) I Love Lucy (C)
  - (18) Merv Griffin (C)
  - (23) Mike Douglas Show (C)
  - (38-40) Flintstones (C)
  - 4:55 (40) Weather Watch (C)
  - 5:00 (3) Big Valley (C)
  - (18) I Dream of Jeannie (C)
  - (30) News, Sports & Weather (C)
  - (80) I Love Lucy (C)
  - 5:30 (8) Dragnet (C)
  - (33) Hogan's Heroes (C)
  - (30) Gilligan's Island (C)
  - (40) News - Weather & Sports (C)
  - 5:55 (5) What's Happening (C)
  - 6:00 (3-8-22) Weather - Sports and News (C)
  - (18) Wild Wild West (C)
  - (30) To Tell the Truth (C)
  - (40) The Saint (C)
  - 6:30 (3) News with Walter Cronkite (C)
  - (8) News with H.K. Smith and Harry Reasoner (C)
  - (23-30) NBC News (C)
  - 6:55 (40) News (C)
  - 7:00 (3) Judd For The Defense (C)
  - (8) Truth or Consequences (C)
  - (18) Dick Van Dyke (C)
  - (23-30) News - Sports and Weather (C)
  - (40) ABC News (C)
  - 7:30 (8) I Dream of Jeannie (C)
  - (18) Movie Game (C)
  - (23) I Dream of Jeannie (C)
  - (30) Flying Nun (C)
  - (40) Dragnet (C)
  - 8:00 (3) Mark Wilson's Magic Circus (C)
  - (23-30) Flip Wilson Show (C)
  - Guests: Johnny Cash, June Carter and Jim Brown.
  - (8-40) Allas Smith and Jones (18) Movie
  - "Never Say Goodbye" Eleanor Parker, Error Flynn.
  - 9:00 (3) LBJ: Lyndon Johnson Talks Politics (C)
  - Special, informal conversation with former President conducted by Walter Cronkite. Fourth in continuing series, "LBJ."
  - (23-30) Ironside (C)
  - (8-40) Longstreet (C)
  - 9:30 (18) Candid Camera (C)
  - (3) CBS Reports (C)
  - 10:00 "A Night in Jail, A Day in Court" Account of experiences of two young men accused of crime and their encounters with American judicial system.
  - (23-30) Dean Martin Show (C)
  - Guests are Raymond Burr, Bob Newhart and Elaine Strich.
  - (8-40) Owen Marshall Counselor at Law (C)
  - (18) News - Weather & Sports (C)
  - 10:30 (18) Hartford Talk-In (C)
  - 11:00 (3-8-23-30-40) News - Weather and Sports (C)
  - (18) Unabridged (C)
  - 11:25 (3) Movies (C)
  - "Robbery" '67. Man masterminds three million dollar mail train heist and almost gets away with it. Stanley Baker, Joanna Pettet, James Booth.
  - "The Three Outlaws" '56. Neville Brand, Bruce Bennett, Alan Hale Jr.
  - 11:30 (23-30) Tonight Show Johnny Carson (C)
  - (8-40) Dick Cavett Show (C)
  - 1:00 (8) Local News Headlines (C)
  - (30) News & Sign Off (C)
  - (40) Prayer & Sign Off (C)
  - 2:35 (3) News - Prayer & Sign Off

Soap Writer Returns

After an absence of almost three years, Irma Phillips is returning as head writer of the CBS Television Network's long-running daytime serial, "As the World Turns."

Miss Phillips created and began writing the "As the World Turns" series in April 1966 and has been associated with the daytime serial for 14 of its 18 years on the air.

FRIDAY

- Friday, January 28
- 1:00 (3) Virginia Graham Show (C)
  - (8) What's My Line? (C)
  - (23) At Home With Kitty (C)
  - "Fashions in Sewing"
  - (30) Tales of Wells Fargo (C)
  - (40) All My Children (C)
  - 1:30 (3) As the World Turns (C)
  - (30) Three On a Match (C)
  - (8-40) Let's Make a Deal (C)
  - 2:00 (8) Love Is a Many Splendored Thing (C)
  - (23-30) Days of Our Lives (C)
  - (8-40) Newlywed Game (C)
  - 2:30 (3) Guiding Light (C)
  - (23-30) The Doctors (C)
  - (8-40) Dating Game (C)
  - 3:00 (3) My Three Sons (C)
  - (23-30) Another World (C)
  - (8-40) General Hospital (C)
  - 3:30 (3) Ranger Station (C)
  - (23-30) Bright Promise (C)
  - (8-40) One Life to Live (C)
  - (18) Gomer Pyle (C)
  - 4:00 (3) Family Affair (C)
  - (23-30) Somerset (C)
  - (8-40) Love American Style (C)
  - (18) Pete and Willy (C)
  - 4:30 (3) Andy Griffith Show (C)
  - (8) I Love Lucy (C)
  - (18) Merv Griffin (C)
  - (23) Mike Douglas Show (C)
  - (38-40) Flintstones (C)
  - 4:55 (40) Weather Watch (C)
  - 5:00 (3) Big Valley (C)
  - (18) I Dream of Jeannie (C)
  - (30) News, Sports & Weather (C)
  - (80) I Love Lucy (C)
  - 5:30 (8) Dragnet (C)
  - (33) Hogan's Heroes (C)
  - (30) Gilligan's Island (C)
  - (40) News - Weather & Sports (C)
  - 5:55 (5) What's Happening (C)
  - 6:00 (3-8-22) News - Sports & Weather (C)
  - (18) Wild Wild West (C)
  - (30) To Tell the Truth (C)
  - (40) The Saint (C)
  - 6:30 (3) News with Walter Cronkite (C)
  - (8) News - Howard K. Smith and Harry Reasoner (C)
  - (23-30) NBC News (C)
  - 6:55 (40) News (C)
  - 7:00 (3) Judd For The Defense (C)
  - (8) Truth or Consequences (C)
  - (18) Dick Van Dyke (C)
  - (23-30) News - Weather & Sports (C)
  - (40) ABC News (C)
  - 7:30 (8) I Dream of Jeannie (C)
  - (18) Movie Game (C)
  - (23) I Dream of Jeannie (C)
  - (30) Hollywood Squares (C)
  - (40) Dragnet (C)
  - 8:00 (3) O'Hara, U.S. Treasury (C)
  - (23-30) Sanford and Son (C)
  - Red Fox & Demond Wilson.
  - (8-40) Brady Bunch (C)
  - 8:30 (3) Movies (C)
  - "The Woman in White" Eleanor Parker, Alexis Smith.
  - 8:50 (23-30) Chronicle (C)
  - News monthly tv magazine. Garrick Utley is host.
  - (8-40) Partridge Family (C)
  - 9:00 (3) Movie
  - "She Waits" Patty Duke, David McCallum, Lew Ayres & Dorothy McGuire. Chilling contemporary ghost story about young wife possessed by avenging spirit of her husband's murdered first wife.
  - 9:30 (8-40) The Odd Couple (C)
  - (18) Candid Camera
  - Guest: Marty Ingels
  - 10:00 (8-40) Love American Style (C)
  - (18) News - Sports & Weather (C)
  - 10:30 (3) Don Rickles Show (C)
  - (18) Hartford Talk-In (C)



Stephanie Powers guest-stars in "Owen Marshall, Counselor at Law," 10 p.m. Thursday on ABC.



Brigitte Bardot appears on NBC News' "Chronolog," Friday at 8:30 p.m.

- (23) This Is Your Life (C)
- Surprise Guest: Leroy "Satchel" Paige.
- (30) The Goldiggers (C)
- Guest host Sebastian Cabot.
- 11:00 (3-8-23-30-40) News - Weather Sports (C)
- (18) Omar and Walter Show (C)
- 11:25 (3) Movies (C)
- "How I Spent My Summer Vacation" '67. Young man bites off more than he can chew when he thinks he has goods on influential millionaire and tries to make good his boast. Robert Wagner, Lola Albright, Peter Lawford.
- "The Canadians" Robert Ryan, John Deiner, and Torm Thatcher.
- 11:30 (23-30) Tonight Show Johnny Carson, host (C)
- (8-40) Dick Cavett Show (C)
- (18) Local News Headlines (C)
- (30) Carol's Wrestling (C)
- (30) News & Sign Off (C)
- (40) Prayer & Sign Off (C)
- 2:35 (3) News - Prayer & Sign Off

Edward VIII Film

Faye Dunaway and Richard Chamberlain have been signed to star as Wallis Simpson and King Edward VIII in "For the Woman I Love," a one-hour film to be produced for the ABC Television Network by Universal Television.

The love story, written by John McGreevey, covers the period immediately prior to the empire-rocking abdication of the king and his irrevocable decision to marry the American-born divorcee.

In Cade's County

Chief Dan George, who received an Academy Award nomination for his performance in the motion picture "Little Big Man," will portray an Indian whose strong philosophical beliefs in non-violence prevent him from identifying a killer, in an upcoming episode of "Cade's County," starring Glenn Ford, on the CBS Television Network.

on "Love of Life" weekdays on the CBS Television Network, learned to play piano by ear when she was 5 years old. Now, at the ripe age of 11, Irene plays castanets, maracas, conga drums and tambourines.

Public TV (WEDH, Channel 24)

- Sunday, January 23
- PM
  - 4:00 Playing Guitar with Fred Neid (C)
  - "Ligado Technique" (C)
  - 4:30 Speaking Freely (C)
  - Lee Cardinal Susagna, Cardinal Archbishop of Malines in Belgium and one of chief architects of Vatican II discusses role and structure of church.
  - 5:00 Szabowski in Rehearsal (C)
  - Part I the Yale Collegium at New Haven.
  - 6:30 Private Lives of Americans B "Mike and Lee Moore" (C)
  - 7:00 Zoom For children (C)
  - 7:30 French Chef (C)
  - "The Hollandaise Family" - understanding the egg yolk in key to marvelous hollandaise and bizarre sauces as Julia Child demonstrates.
  - 8:00 Flying Line (C)
  - 9:00 Masterpiece Theatre "Anne of Cleves" (C)
  - 10:45 David Littlejohn - Critic-at-Large (C)
  - "Selling the Moon"
- Monday, January 24
- PM
  - 6:00 Hodgepodge Lodge (C)
  - "Spongers" (C)
  - 6:30 Playing Guitar with Fred Neid (C)
  - 7:00 Free-For-All (C)
  - 7:30 Connecticut Newsroom
  - 8:00 Special of the Week (C)
  - "Paradise Lost" - Special portrayal of middle-class American family in '30's and effects of Depression on their lives Bill Wallace & Jo Van Fleet.
- Tuesday, January 25
- PM
  - 6:00 Zoom (C)
  - 6:30 Communications & Education "Conversation with J. E. Allen" (C)
  - 7:00 Book Beat "Four Russell's Almanac" by Russell Baker - New York Times humorist produces modern version of homespun almanac which covers 365 hilarious days of new year.
  - 7:30 Connecticut Newsroom
  - 8:00 Fourth Estate (C)
  - 8:30 The Advocates (C)
  - "Should we drastically reduce our troop commitments in Europe?"
  - 10:00 How Do Your Children Grow? "If I were my teenage child, what would I think of me?"
  - 10:30 Japan Society Presents "Art of the Woodblock" Shiro Munakata, Japan's foremost contemporary woodcut artist, demonstrates his art in film that captures his forceful technique and breathtaking spontaneity.
- Wednesday, January 26
- PM
  - 6:00 Hodgepodge Lodge (C)
  - 6:30 Communications & Education "The Case for ITV (part I)" (C)
  - 7:00 Free-For-All (C)
  - 7:30 Connecticut Newsroom
  - 8:00 Private Lives of Americans "Ed Nylund, Librarian" - Portrait of a man in his late fifties who works in library and in his private life is playwright, actor, composer and superb cellist.
  - 8:30 This Week (C)
  - 9:00 Great American Dream Machine (C)
  - 10:00 Soul (C)
- Thursday, January 27
- PM
  - 6:00 Zoom (C)
  - 6:30 Technology For Tomorrow "Plastics" (C)
  - 7:00 The Dear Citizen
  - 7:30 Connecticut Newsroom
  - 8:00 30 Minutes (C)
  - 8:30 New Playhouse Biography (C)
  - 10:00 World Press (C)
  - 10:45 David Littlejohn - Critic-at-Large (C)
  - "A Week on the London Stage"
- Friday, January 28
- PM
  - 6:00 Hodgepodge Lodge (C)
  - "Seasoning" (C)
  - 6:30 Zoom (C)
  - 7:00 Japan Society Presents "Art of the Woodblock" (C)
  - 7:30 Wall Street Week (C)
  - 8:00 Washington Week in Review (C)
  - 8:30 Ed Nylund (C)
  - "Grand Illusion" - Film masterpiece about WW I and social change it brought about Jean Gabin & Pierre Fresnay.
  - 10:30 Private Lives of Americans B "Ed Nylund, Librarian"

Top in Pop Poll

For the second year in succession, Doc Severinsen, music director of NBC-TV's "The Tonight Show Starring Johnny Carson," has been named winner in the Trumpet and Big Band Leader categories of the annual Playboy All-Star Jazz and Pop Poll.

TV Tidbits

Dick Shawn, host of NBC-TV's "Highlights of Ringling Bros. and Barnum & Bailey Circus" on NBC-TV Feb. 27, once played opposite Arnold Palmer in a golf tournament and hit the ball farther than the golfing great on the first hole. "But that was the only hole I won," Shawn confessed.

Series star Raymond Burr directs his first "Ironside" episode, "Achilles Heel," on NBC-TV Feb. 10. "Ironside" is now in its fifth season.

On NBC-TV's "The Who, What or Where Game" Jan. 3rd, contestant Bob McGreevy, an attorney of Kew Gardens, Queens, N.Y., won \$3,595 in prize money, making him the highest one-day money winner in the two-year history of the daytime game series.

THE POWERFUL PERFORMER ON ON OFF THE ROAD

HONDA 450 SCRAMBLER

SERVICE IS OUR SYMBOL

Financing Arranged

Kawasaki - Ossa

Honda

MANCHESTER HONDA CENTER

834 Center St., Manchester

Our SPEEDY Specialty TRULY DELICIOUS CHICKEN

Brown in 6 Minutes

The world's "finest eating chicken" with incomparable taste.

CALL IN ORDER Pick Up 10 Minutes Later

DECI'S DRIVE-IN

462 CENTER ST. - 643-2000

SHOP and SAVE WHERE YOU SEE THIS SIGN

PLEN'S TEXACO

381 MAIN ST.

GORMAN BROS.

770 MAIN ST.

Stanek ELECTRONICS LABORATORIES

277 BROAD

F.M. AND A.M. CAR STEREO RADIOS

TV-Radio Sales and Service

L. T. WOOD - Atlantic Fuel Oil

643-1129

FOR 24-HOUR BURNER SERVICE, TEL. 649-3701

Don WILLIS Garage

SPECIALISTS IN WHEEL ALIGNMENT AND BRAKE SERVICE

GENERAL AUTO REPAIR

649-4531 - 12 MAIN ST., MANCHESTER

Alignment Wheel